



EQT | EXETER



1140 Ringwood Court

San Jose, CA

Building Size: 52,440 SF | 52,440 SF of Industrial Space Available

VISIT [EQTEXETER.COM](https://eqtexeter.com)

1140 Ringwood Court

San Jose, CA

Building Size: 52,440 SF | Building Availability: 52,440 SF

Building Specifications

- Industrial space available
- 52,440 SF total building size
- 52,440 SF available size
- Warehouse area for shipping/receiving
- Mix of office, lab and open ceiling manufacturing/warehouse
- Dock and grade level loading
- ±3.3/1000 parking
- 100% HVAC
- 2,000 amps @ 277/480V
- Showers and lockers
- Outdoor sports court
- New roof
- Floor Plan update underway



1140 Ringwood Court

San Jose, CA

Building Size: 52,440 SF | Building Availability: 52,440 SF

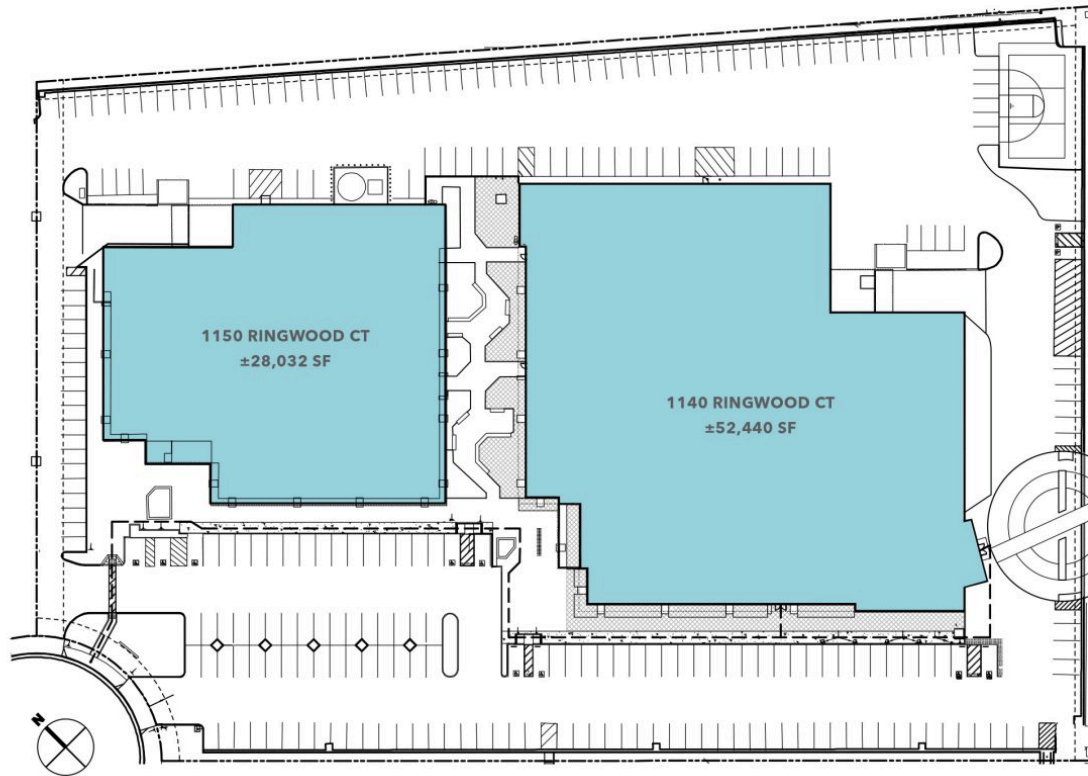

1140 Ringwood Court

San Jose, CA

Building Size: 52,440 SF | Building Availability: 52,440 SF

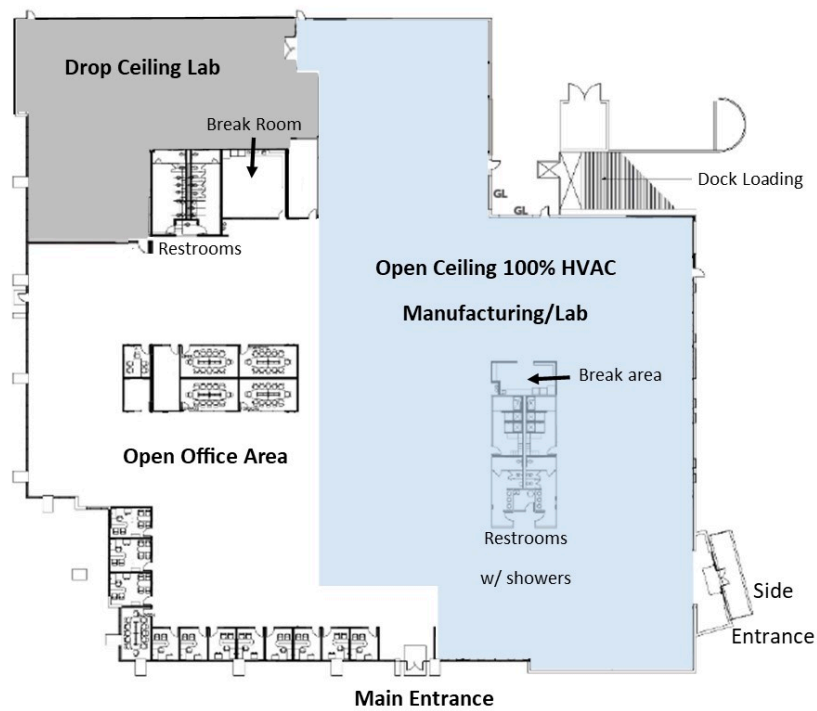

Location

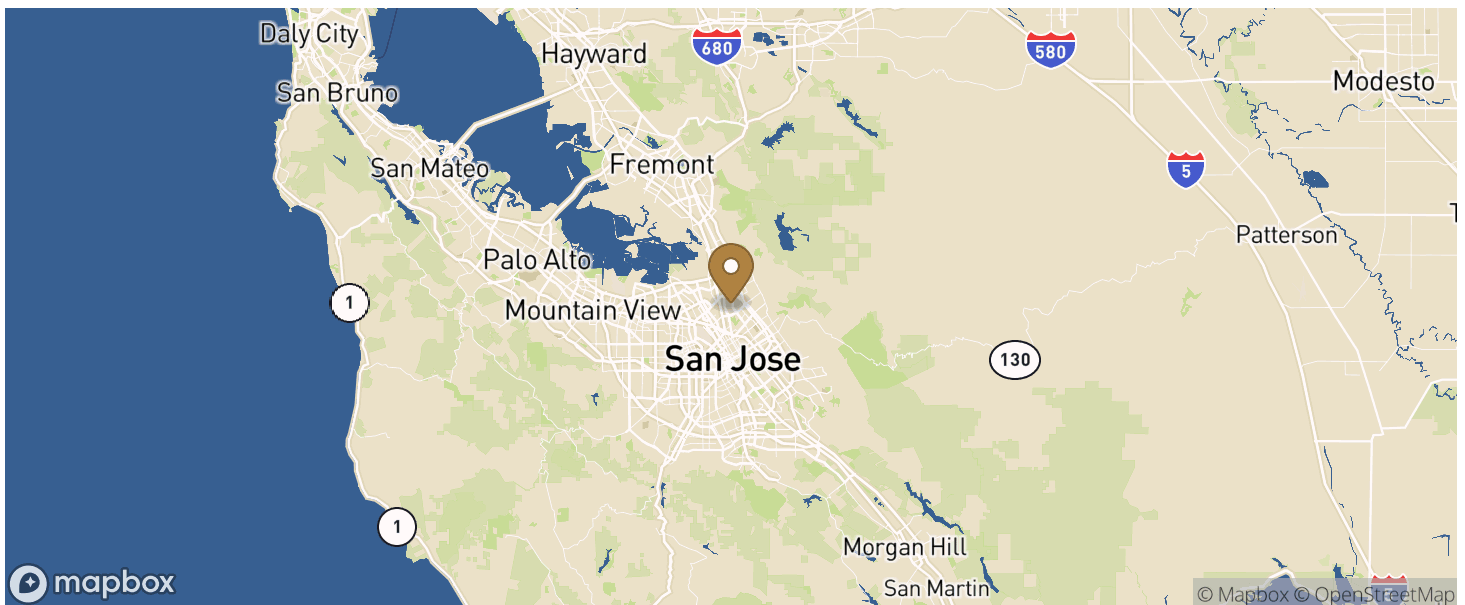

Population

ACCESS AND LABOR FORCE	10 MILES
Total Population	1,348,054
Total Labor Force	887,020
Unemployment Rate	2.48%
Median Household Income	126,527
Warehouse Employees	1,089
High School Education Or Higher	66.50%

Transportation

Transit		
Bus, Lundy Avenue & McKay Drive	6 min walk	0.3 miles