



EQT | EXETER



3901 Stonecroft Boulevard

Chantilly, VA

Building Size: 101,530 SF | 25,598 SF of Industrial Space Available

VISIT [EQTEXETER.COM](https://eqtexeter.com)

3901 Stonecroft Boulevard

Chantilly, VA

Building Size: 101,530 SF | Building Availability: 25,598 SF

Building Specifications

- Industrial space available
- 101,530 SF total building size
- 25,598 SF available size
- New energy efficient lighting
- Office/warehouse space with 20' clear ceilings
- 4.0 per 1,000 SF parking ratio
- Fully air-conditioned
- Cox Communication and Verizon fiber optic

Additional Information

- Located in Avion Business Park, minutes from Dulles International Airport

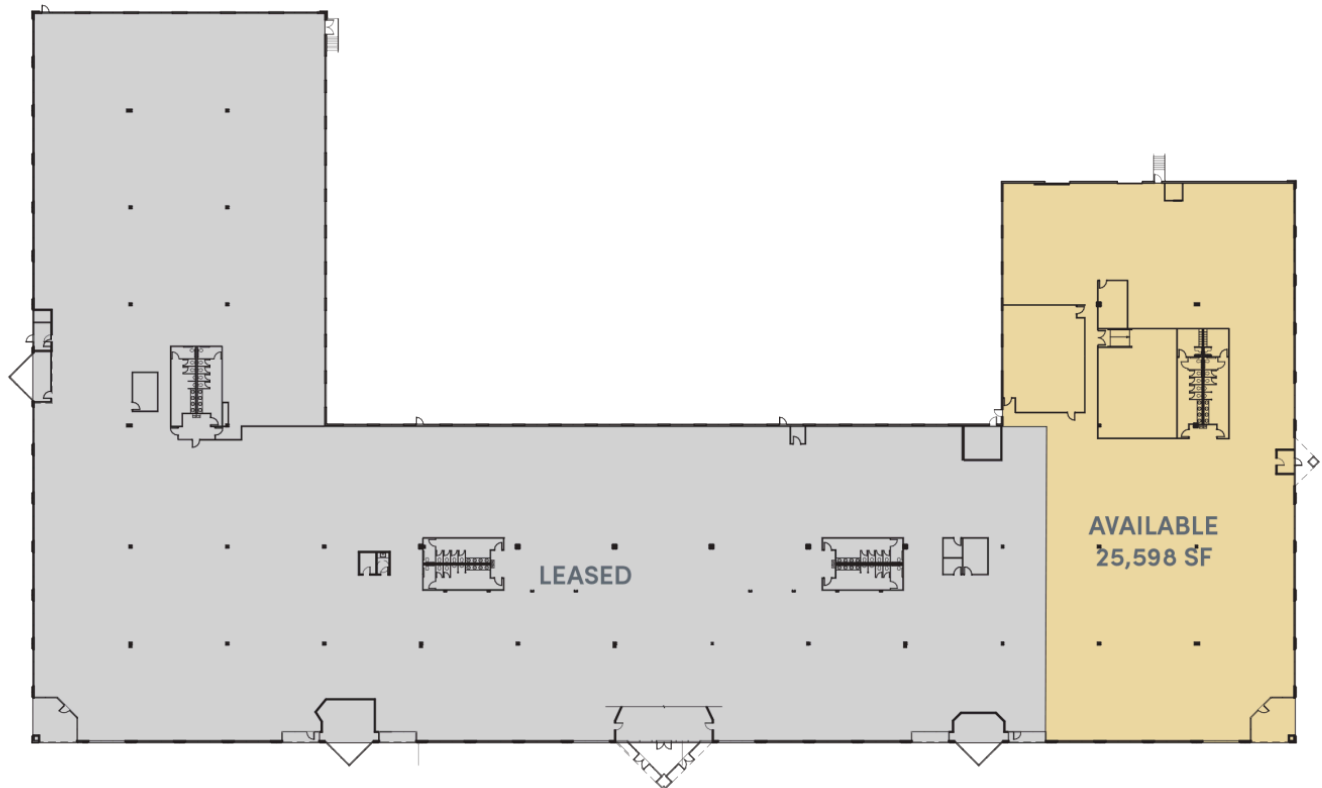

Location

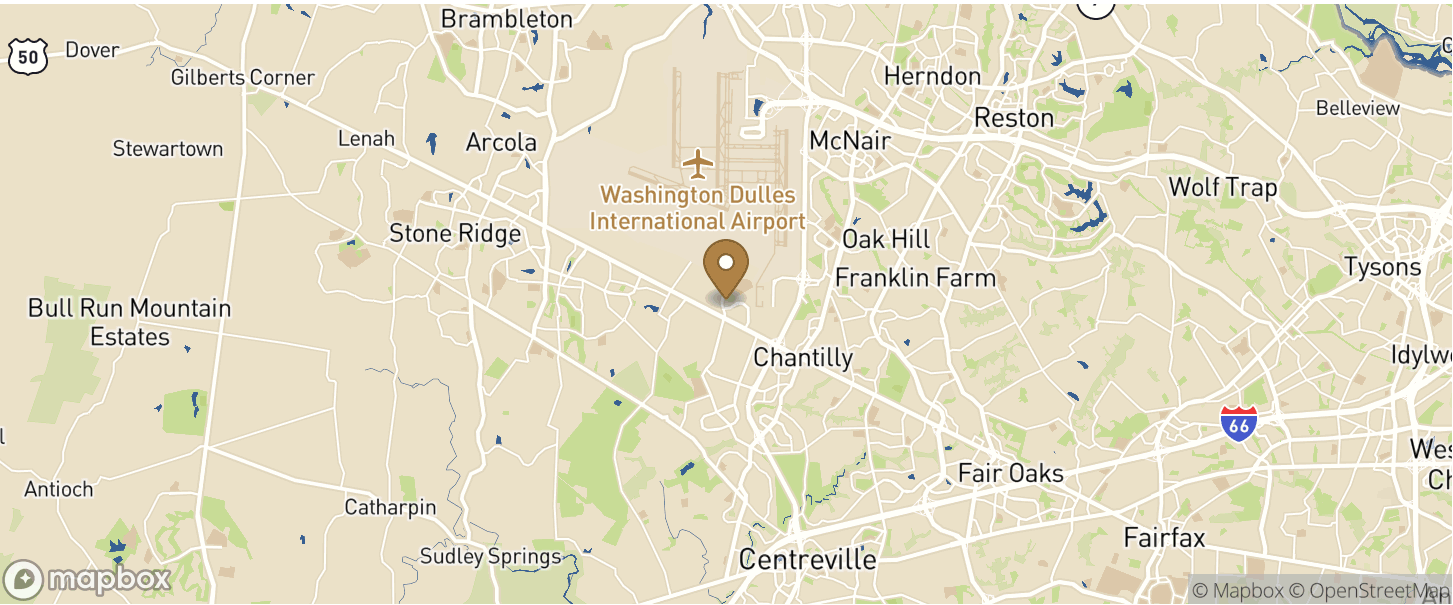

Population

ACCESS AND LABOR FORCE	10 MILES
Total Population	726,230
Total Labor Force	498,522
Unemployment Rate	1.83%
Median Household Income	131,313
Warehouse Employees	1,507
High School Education Or Higher	65.48%