



EQT | EXETER



# 3771-3797 Corporate Center Drive

Earth City, MO

Building Size: 73,200 SF | 11,400 SF of Industrial Space Available

VISIT [EQTEXETER.COM](https://www.eqtexeter.com)

# 3771-3797 Corporate Center Drive

Earth City, MO

Building Size: 73,200 SF | Building Availability: 11,400 SF

## Building Specifications

- Industrial space available
- 73,200 SF total building size
- 11,400 SF available size
- 4.8/1000 SF parking ratio
- 1 dock door
- 16' clear height
- T-8 lighting
- Wet sprinkler system

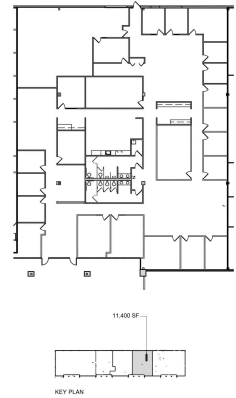

## Additional Information

- Flexible layout up to 100% office available
- Excellent Interstate access to I-70 & I-270
- Exterior building and monument signage available

## Location

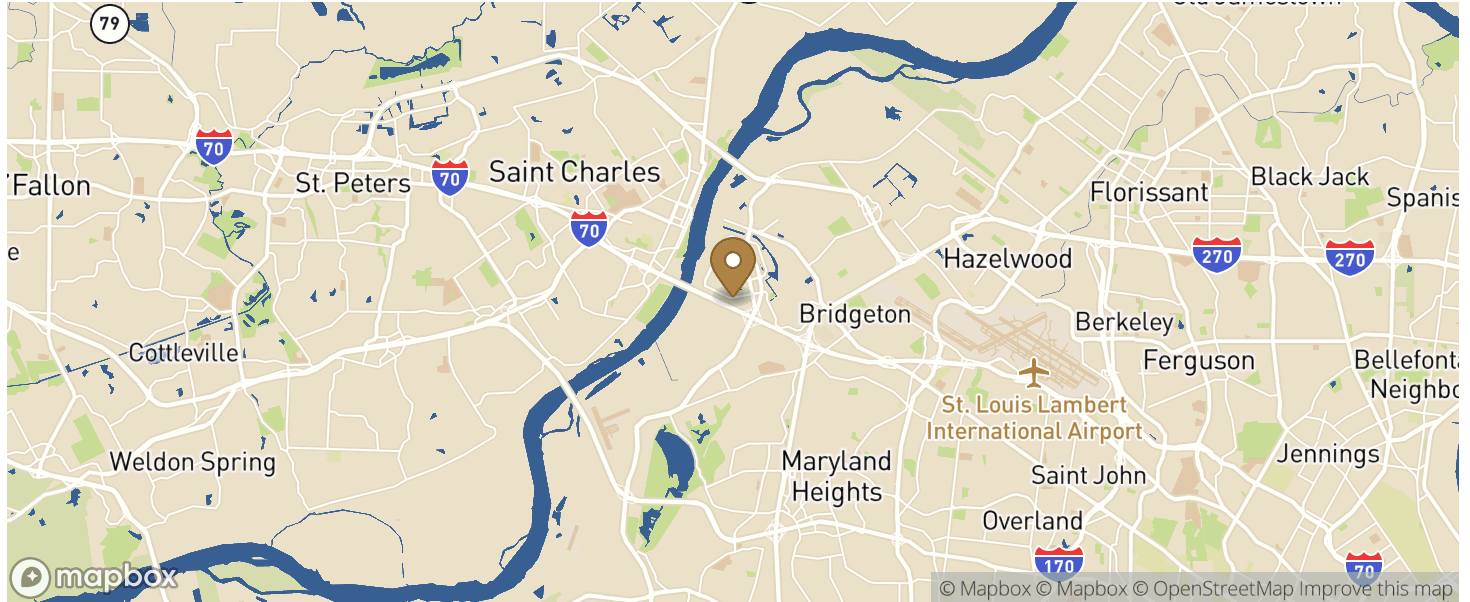

## Access

CITY	POPULATION	MILES	DRIVE TIME
Indianapolis	887,642	255	4 h 08 m
Memphis	633,104	299	4 h 43 m
Chicago	2,746,388	308	4 h 59 m

# 3771-3797 Corporate Center Drive

Earth City, MO

Building Size: 73,200 SF | Building Availability: 11,400 SF

Nashville	684,410	327	5 h 12 m
Nashville-Davidson (balance), Tennessee	601,222	329	5 h 14 m
Milwaukee	600,155	392	6 h 06 m

## Population

ACCESS AND LABOR FORCE			10 MILES
Total Population			0
Total Labor Force			0
Unemployment Rate			0.00%
Median Household Income			0
Warehouse Employees			0
High School Education Or Higher			0.00%