



EQT | EXETER



# 1245 Trapp Road

Eagan, Minnesota

Building Size: 180,480 SF

VISIT [EQTEXETER.COM](http://EQTEXETER.COM)

# 1245 Trapp Road

Eagan, Minnesota

**Building Size:** 180,480 SF

## Building Specifications

- Industrial space
- 180,480 SF total building size
- **Fully Leased**
- 180,480 SF total building size
- 24' Clear
- Column Spacing: 40'x40'
- ESFR sprinkler system
- Year Constructed: 1998
- Located in Trapp Road Commerce Center
- Power: 480-volt 200-amp 3-phase
- Immediate access to I-494, I-35E, Hwy 13 and Hwy 55

## Additional Information

### Unit A

- 32,896 SF available
- 11,838 Office SF
- 8 dock doors
- 1 drive-in door
- 58 car parking



# 1245 Trapp Road

Eagan, Minnesota

Building Size: 180,480 SF

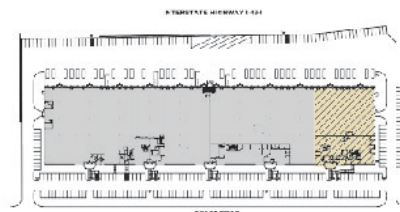
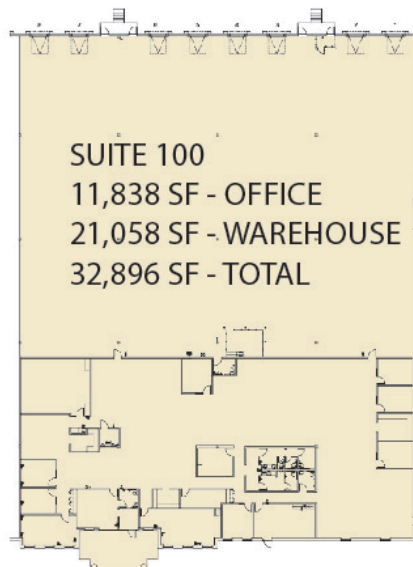

# 1245 Trapp Road

Eagan, Minnesota

Building Size: 180,480 SF

## Location

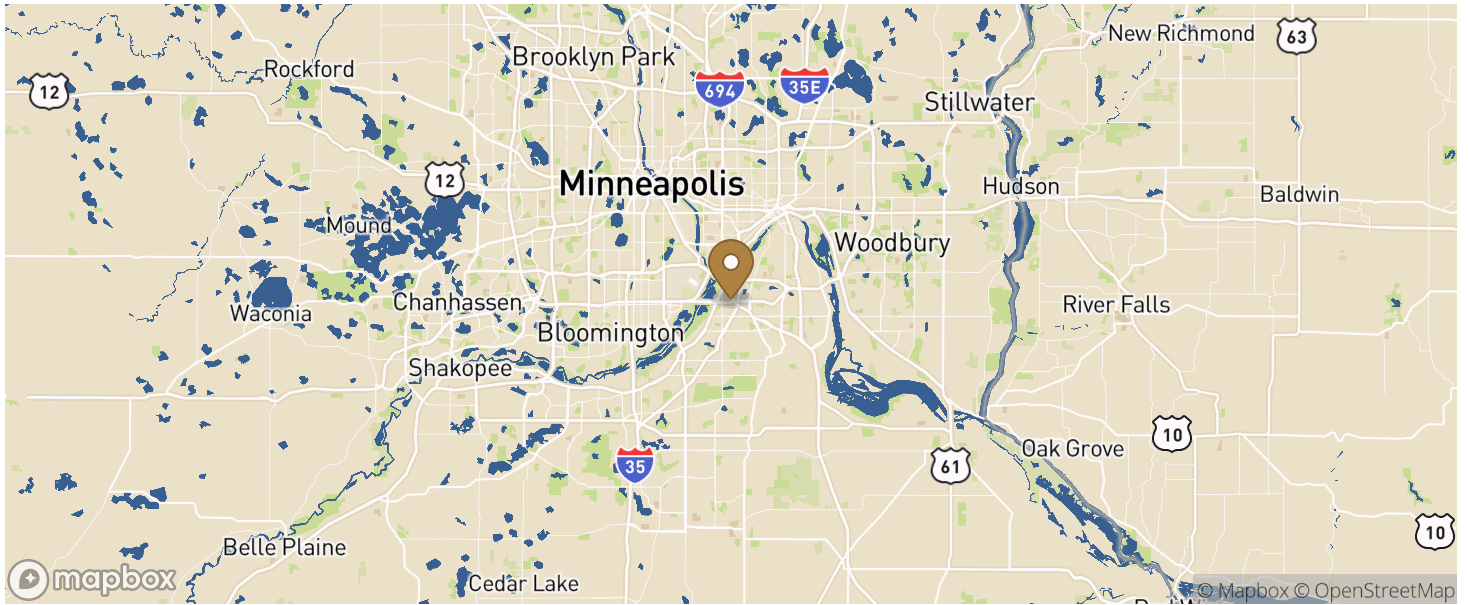

## Transportation

### Airport

Minneapolis–Saint Paul International Airport 10 min drive 5 miles

### Highway

Interstate 494 3 min drive 1 miles

Interstate I-35E 4 min drive 2 miles

Highway 55 1 min drive 0.5 miles

### City

St. Paul CBD 15 min drive 9.1 miles

Minneapolis CBD 17 min drive 10.8 miles