



EQT | EXETER



# 10920 West Sam Houston Parkway N

Houston, Texas

Building Size: 45,775 SF | Building Availability: 10,072 SF

VISIT [EQTEXETER.COM](http://EQTEXETER.COM)

## Building Specifications

Industrial space available:

- 45,775 SF total building size
- 10,072 SF available size
- 19' clear height

Newly renovated:

- Concrete tilt-wall construction

Building Size: 45,775 SF | 10,072 SF of Industrial Space Available

- Excellent access to Hwy 290, 249, I-45 North via Beltway 8
- Professionally landscaped

## Additional Information

- **Suite 400: 6,050 SF Available**
  - 100% Office Space
- **Suite 700: 4,025 SF available for lease**
  - Warehouse: 2,415 SF
  - Office: 1,610 SF
  - 1 Ramp – 1 Semi dock



# 10920 West Sam Houston Parkway N

Houston, Texas

Building Size: 45,775 SF | Building Availability: 10,072 SF

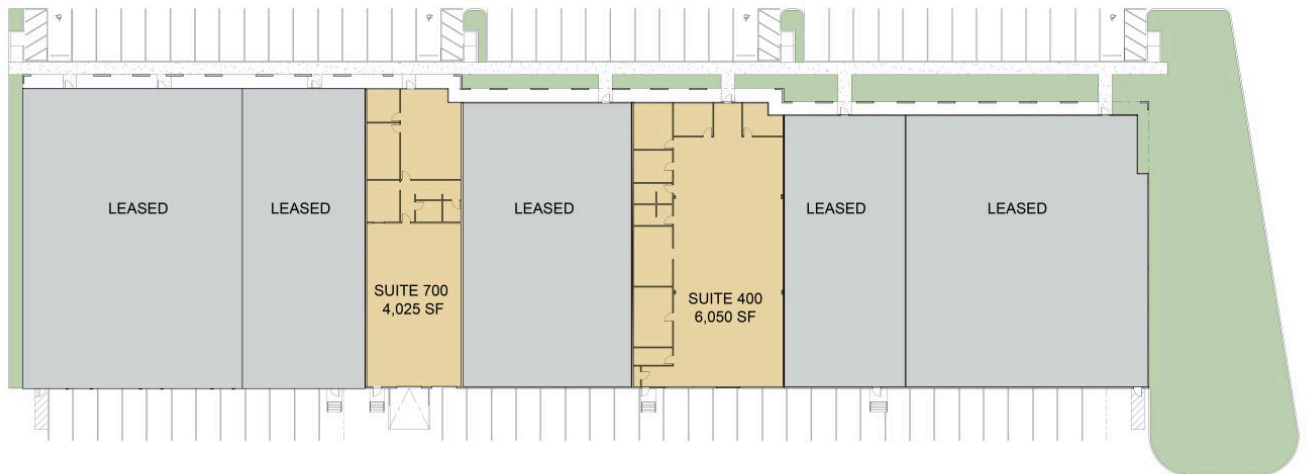

# 10920 West Sam Houston Parkway N

Houston, Texas

Building Size: 45,775 SF | Building Availability: 10,072 SF

## Location

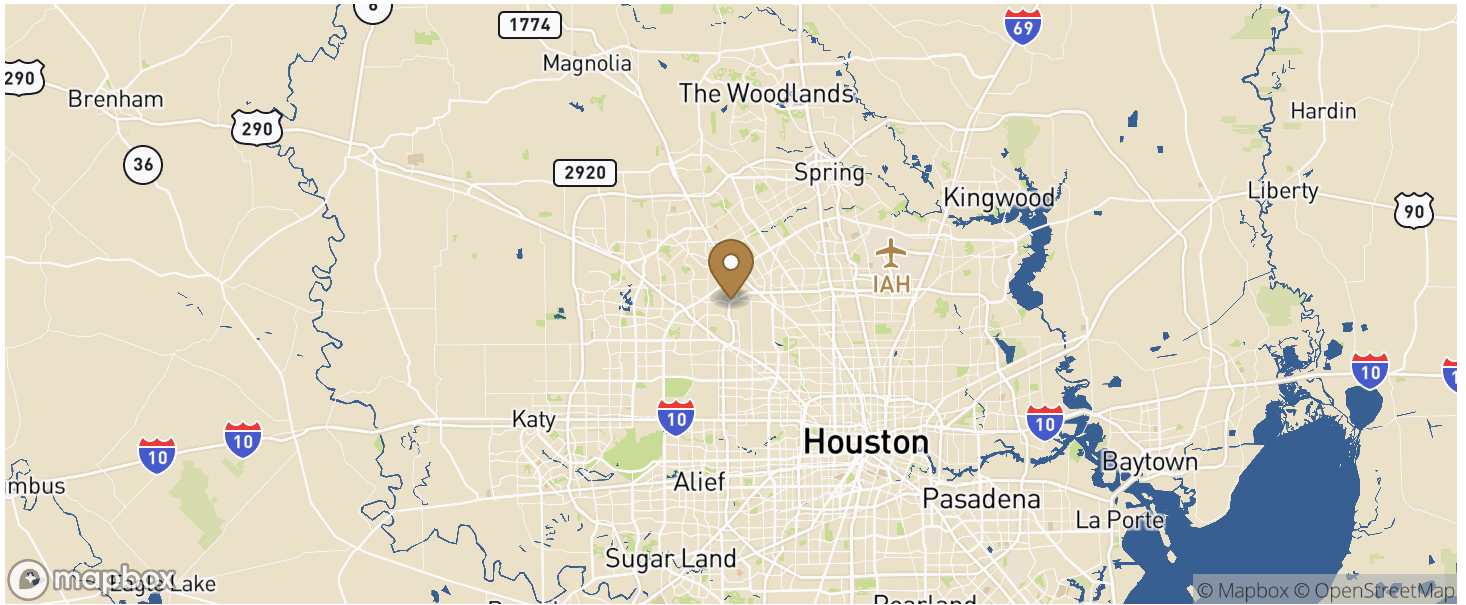

## Population

WITHIN 10 MILES

Total Population	1,179,145
Total Labor Force	633,629
Unemployment Rate	4.18%
Median Household Income	69,301
Warehouse Employees	5,364
High School Education Or Higher	62.91%