



EQT | EXETER



523 Plymouth Road

Plymouth Meeting, PA

Building Size: 37,450 SF | 22,570 SF of Office Space Available

VISIT EQTEXETER.COM

523 Plymouth Road

Plymouth Meeting, PA

Building Size: 37,450 SF | Building Availability: 22,570 SF

Building Specifications

- Office space available
- 37,450 SF total building size
- 22,570 SF available size
- 5.6 acre site
- 10' clear height
- 2 drive-in doors
- 223 car parking spaces
- T-8, T-12 lighting
- Wet sprinkler system



523 Floor Plan

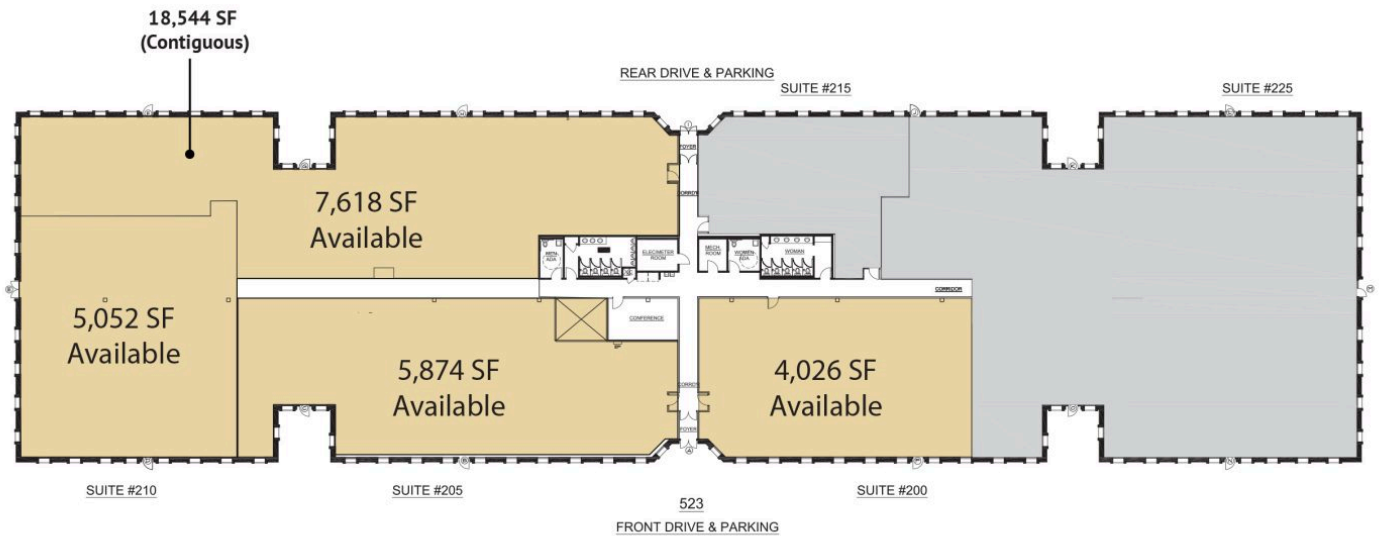

523 Plymouth Road

Plymouth Meeting, PA

Building Size: 37,450 SF | Building Availability: 22,570 SF

Location

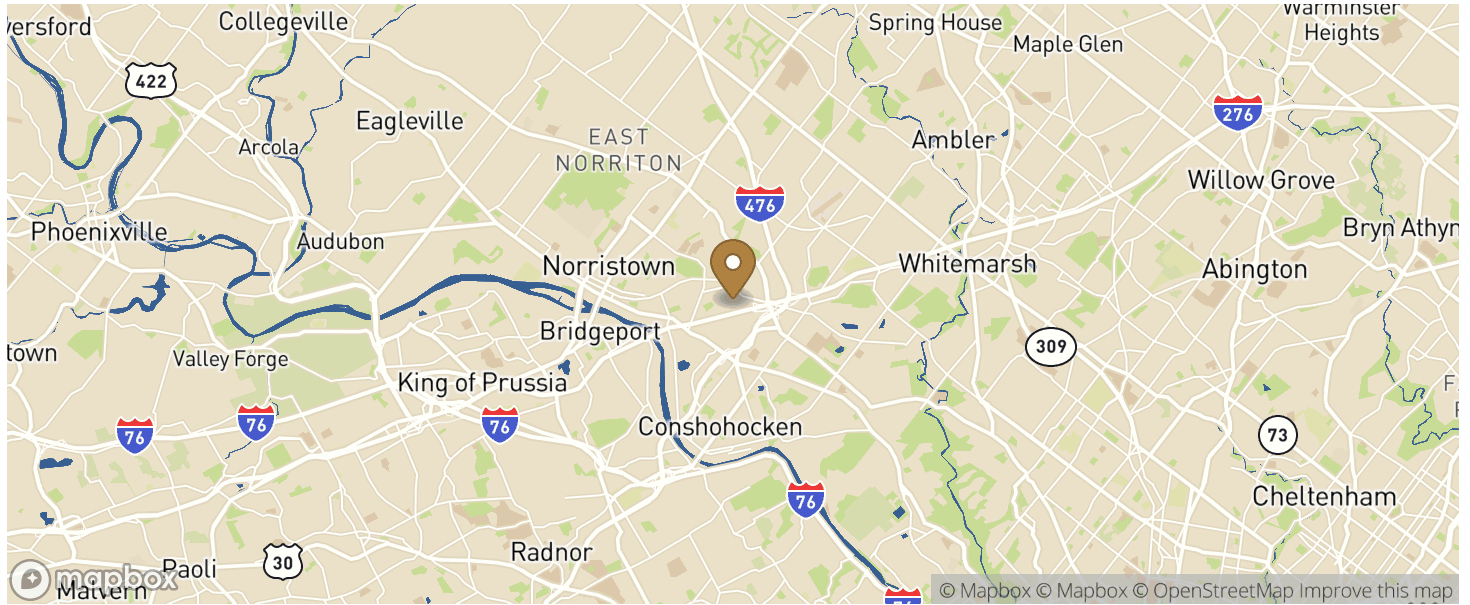

Access

CITY	POPULATION	MILES	DRIVE TIME
New York City	8,804,190	98	1 h 52 m
Manhattan	1,694,251	98	1 h 54 m
Brooklyn	2,736,074	100	2 h 00 m
Queens	2,405,464	105	2 h 17 m
Montreal	1,762,949	456	7 h 29 m
Toronto	2,731,571	463	7 h 59 m

Population

ACCESS AND LABOR FORCE	10 MILES
Total Population	927,096
Total Labor Force	622,575
Unemployment Rate	2.81%
Median Household Income	84,184
Warehouse Employees	993
High School Education Or Higher	69.69%