



EQT | EXETER



1000 Shiloh Road

Plano, Texas

Building Size: 76,317 SF | 13,212 SF of Industrial Space Available

VISIT EQTEXETER.COM

1000 Shiloh Road

Plano, Texas

Building Size: 76,317 SF | Building Availability: 13,212 SF

Building Specifications

- Industrial space available
- 76,317 SF total building size
- 13,212 SF available size
- 76,317 SF building size
- 13,212 SF available size
- Office: 5,672 SF
- Warehouse: 7,540 SF
- Clear Height: 25'
- 9'x10' Dock Doors: 3
- Oversized 14'x16' drive in door with ramp: 1
- 400 amp 3 phase 4 wire electrical service
- LED Warehouse Lighting: 30 FC
- New Whitebox Warehouse
- New Flooring, Paint, Led Lighting, and Renovated Restrooms Throughout Office Areas

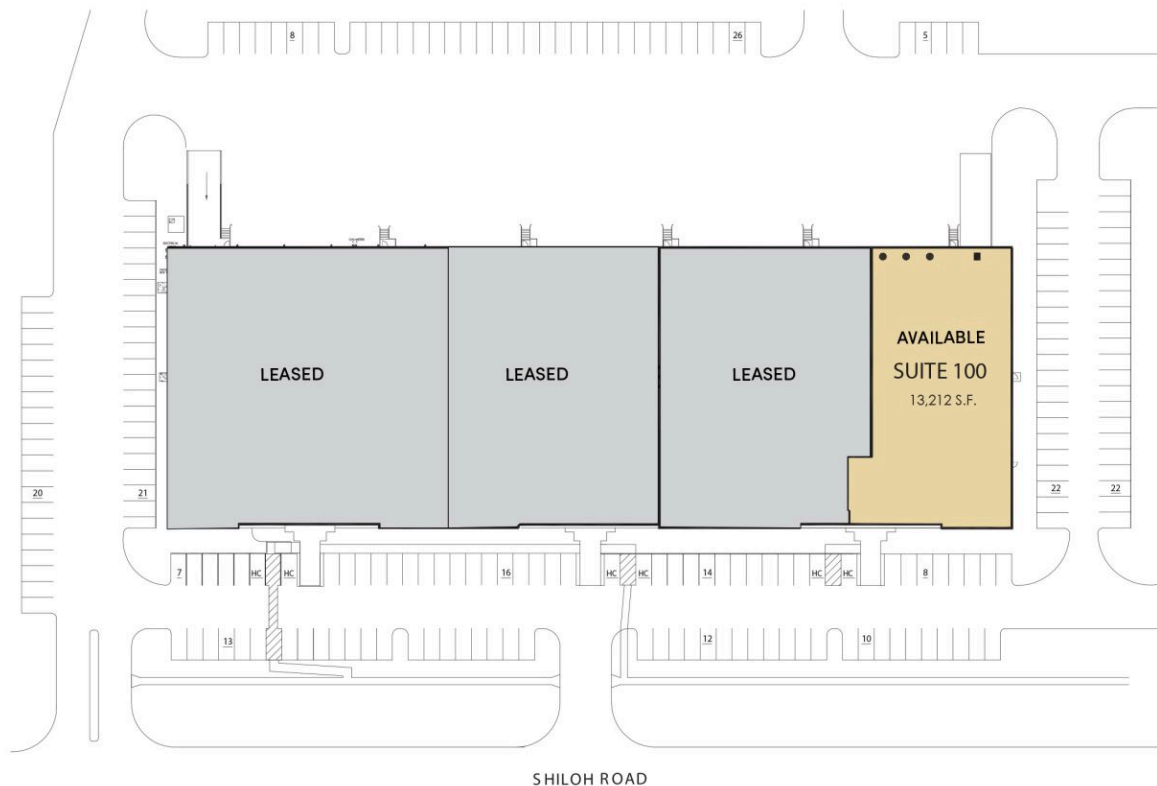

1000 Shiloh Road

Plano, Texas

Building Size: 76,317 SF | Building Availability: 13,212 SF

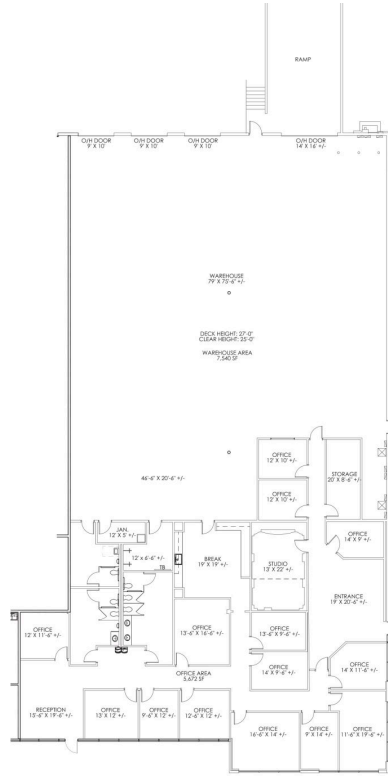

Location

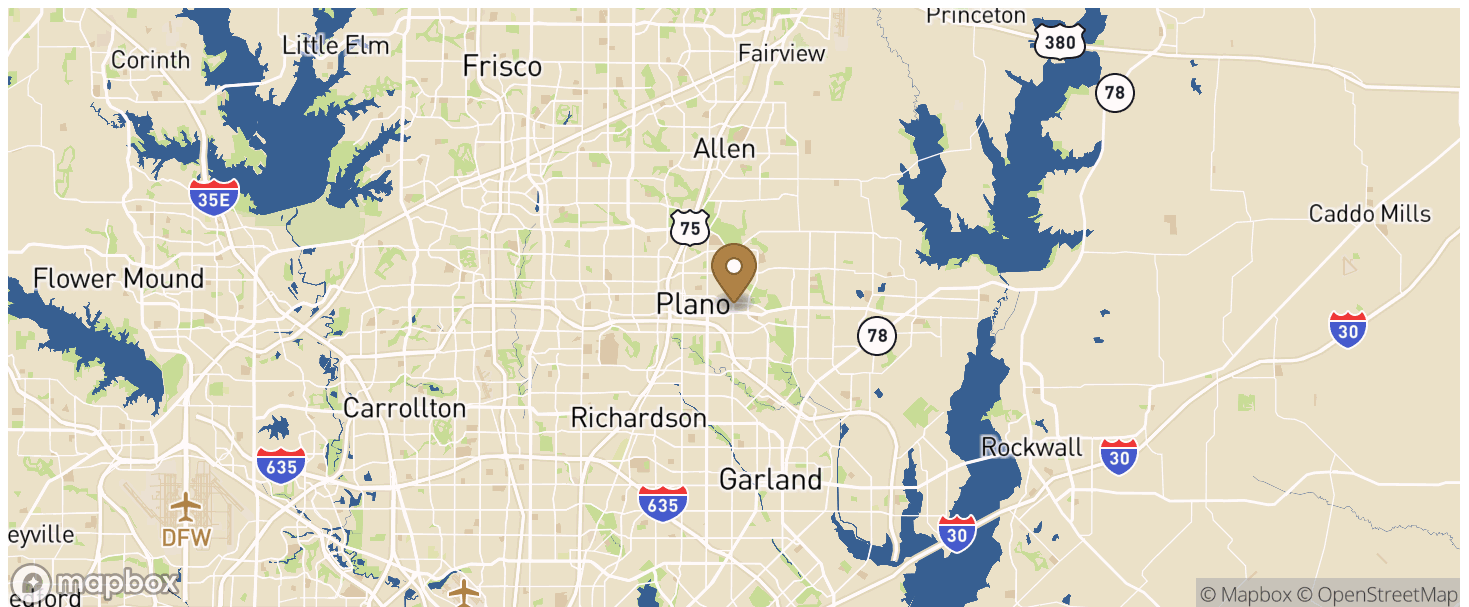

1000 Shiloh Road

Plano, Texas

Building Size: 76,317 SF | Building Availability: 13,212 SF

Population

WITHIN 10 MILES

Total Population	571,924
Total Labor Force	321,844
Unemployment Rate	3.78%
Median Household Income	88,068
Warehouse Employees	2,275
High School Education Or Higher	0.00%