



EQT | EXETER



# 9-19 Commerce Drive

O'Fallon, MO

Building Size: 62,125 SF | 15,036 SF of Industrial Space Available

VISIT [EQTEXETER.COM](https://www.eqtexeter.com)

# 9-19 Commerce Drive

O'Fallon, MO

Building Size: 62,125 SF | Building Availability: 15,036 SF

## Building Specifications

- Industrial space available
- 62,125 SF total building size
- 15,036 SF available size
- ±500 SF office
- Front-loaded
- 24' clear height
- ESFR sprinkler
- 4 docks (9'x10') with levelers
- 40' x 40' column spacing
- Year Built: 1999
- New LED lights in warehouse and office

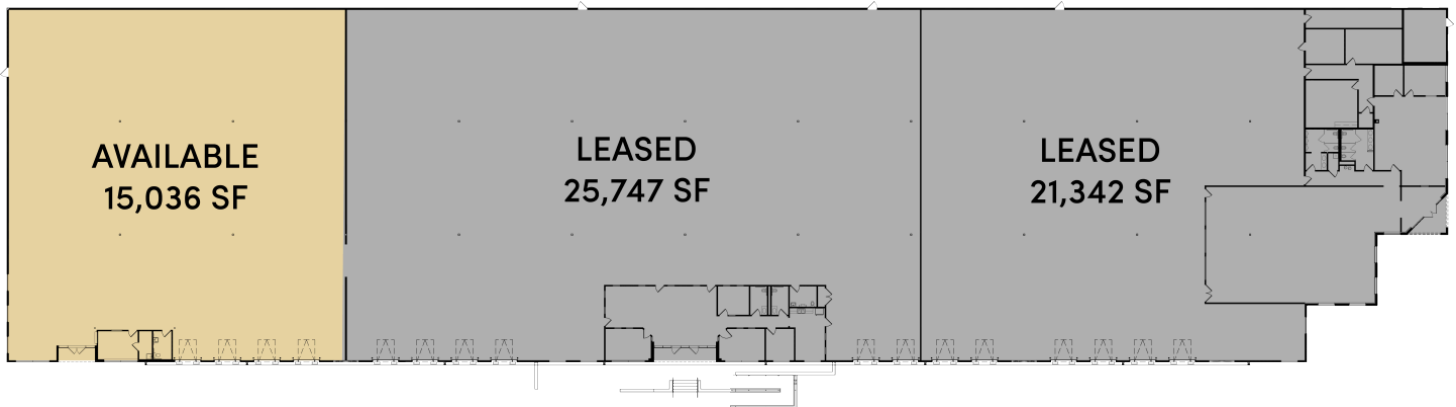

# 9-19 Commerce Drive

O'Fallon, MO

Building Size: 62,125 SF | Building Availability: 15,036 SF

## Location

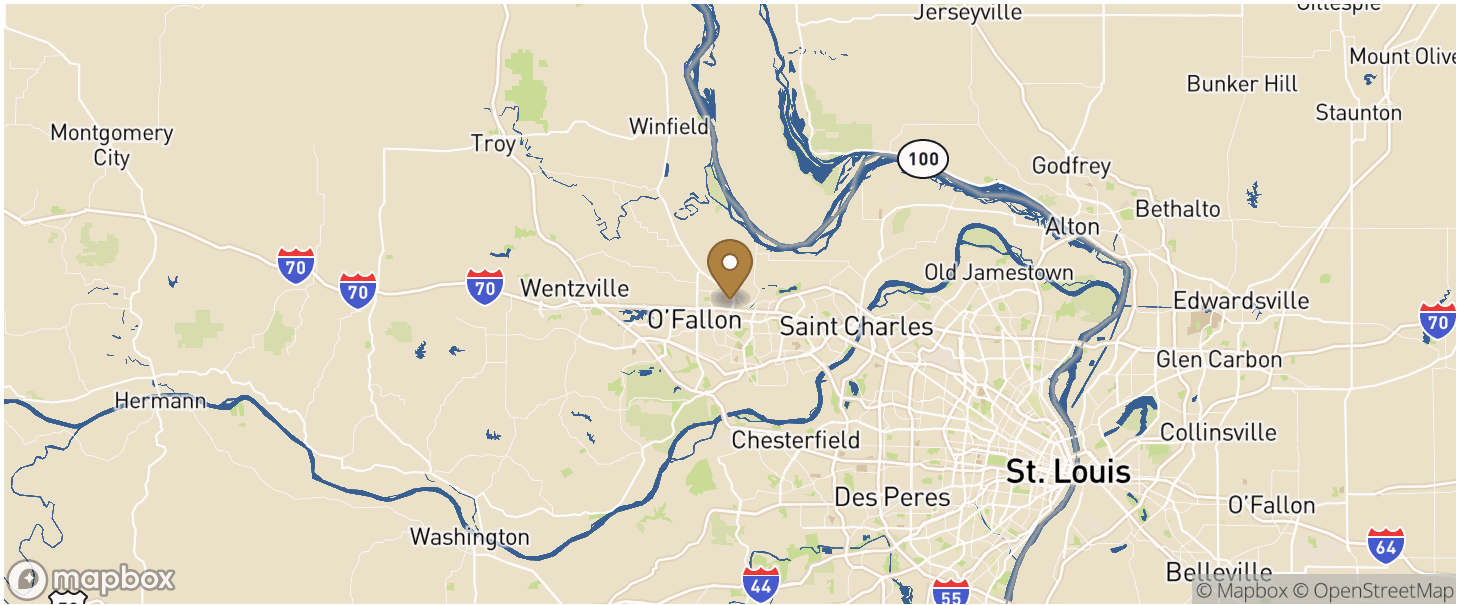

## Population

WITHIN 10 MILES

Total Population	356,894
Total Labor Force	155,621
Unemployment Rate	3.14%
Median Household Income	85,767
Warehouse Employees	4,403
High School Education Or Higher	67.85%