



EQT | EXETER



# 10001 N 92nd Street

Scottsdale, Arizona

Building Size: 116,200 SF | 116,200 SF of Office Space Available

VISIT [EQTEXETER.COM](https://eqtexeter.com)

# 10001 N 92nd Street

Scottsdale, Arizona

Building Size: 116,200 SF | Building Availability: 116,200 SF

## Building Specifications

- Office space available
- 116,200 SF total building size
- 116,200 SF available size
- Two story building
- 5.5/1,000 PSF parking ratio
- Fully furnished outdoor space
- Walking distance to upscale shopping and dining
- Centrally located - Loop 101 access, short drive to Gainey Ranch & McCormick Ranch
- Private entrance
- Coffee bar available in lobby
- Immediately adjacent to HonorHealth Scottsdale
- Covered parking garage
- Building top signage and branding opportunity



### FIRST FLOOR

## 92 Mountainview

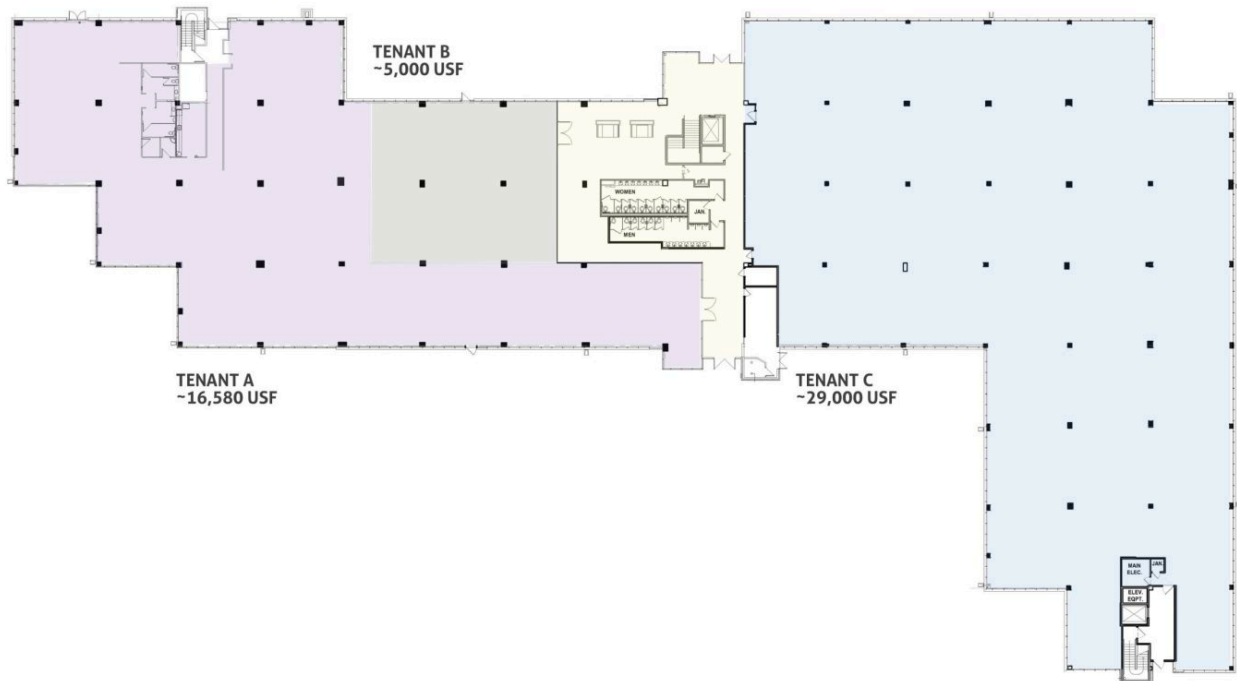



10001 N 92nd Street

Scottsdale, Arizona

Building Size: 116,200 SF | Building Availability: 116,200 SF

SECOND FLOOR

## 92 Mountainview

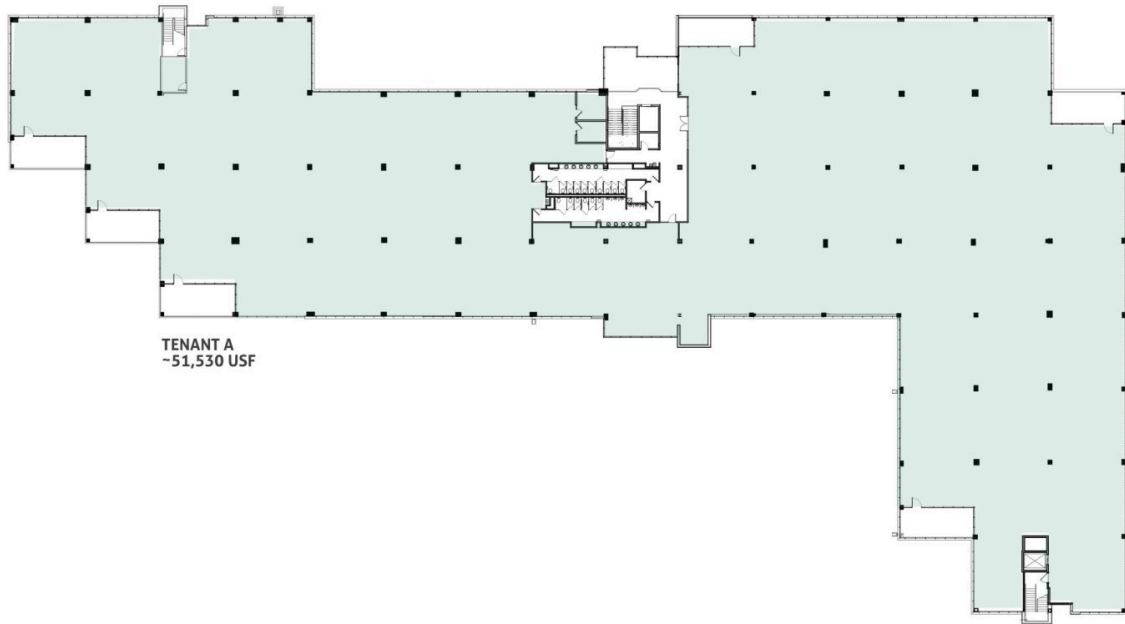

# 10001 N 92nd Street

Scottsdale, Arizona

Building Size: 116,200 SF | Building Availability: 116,200 SF





# 10001 N 92nd Street

Scottsdale, Arizona

Building Size: 116,200 SF | Building Availability: 116,200 SF



# 10001 N 92nd Street

Scottsdale, Arizona

Building Size: 116,200 SF | Building Availability: 116,200 SF

## Location

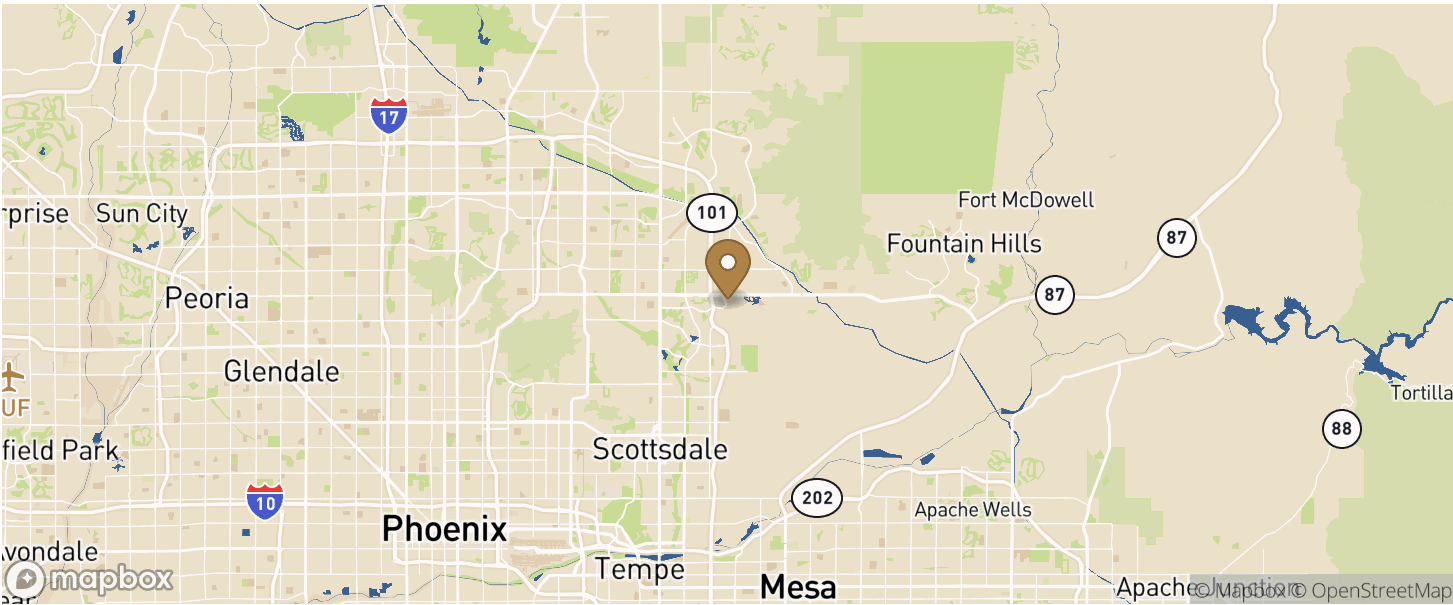

## Population

WITHIN 10 MILES

Total Population	543,988
Total Labor Force	414,843
Unemployment Rate	1.22%
Median Household Income	83,820
Warehouse Employees	3,467
High School Education Or Higher	70.10%

## Transportation

### Transit

Bus	9 min walk	0.5 miles
Bus, Mustang Transit Center	13 min walk	0.7 miles