



EQT | EXETER



North West - St Helens I

St Helens, United Kingdom

Building Size: 109,555 SF | 109,555 SF of Industrial Space Available

VISIT [EQTEXETER.COM](https://www.eqtexeter.com)

North West - St Helens I

St Helens, United Kingdom

Building Size: 109,555 SF | Building Availability: 109,555 SF

Building Specifications

- Industrial space available
- 109,555 SF total building size
- 109,555 SF available size
- 16,985 SF of office space
- 31' to 31' clear height
- 60 car parking spaces

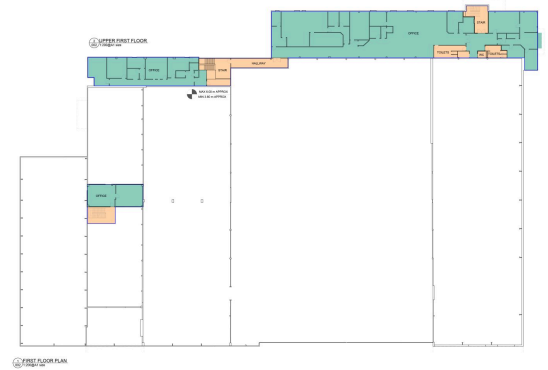

	OFFICE	896.08 SQ M	9,607.04 SQ FT
	ANCILLARY	1,088.57 SQ M	11,681.50 SQ FT



North West - St Helens I

St Helens, United Kingdom

Building Size: 109,555 SF | Building Availability: 109,555 SF

Location

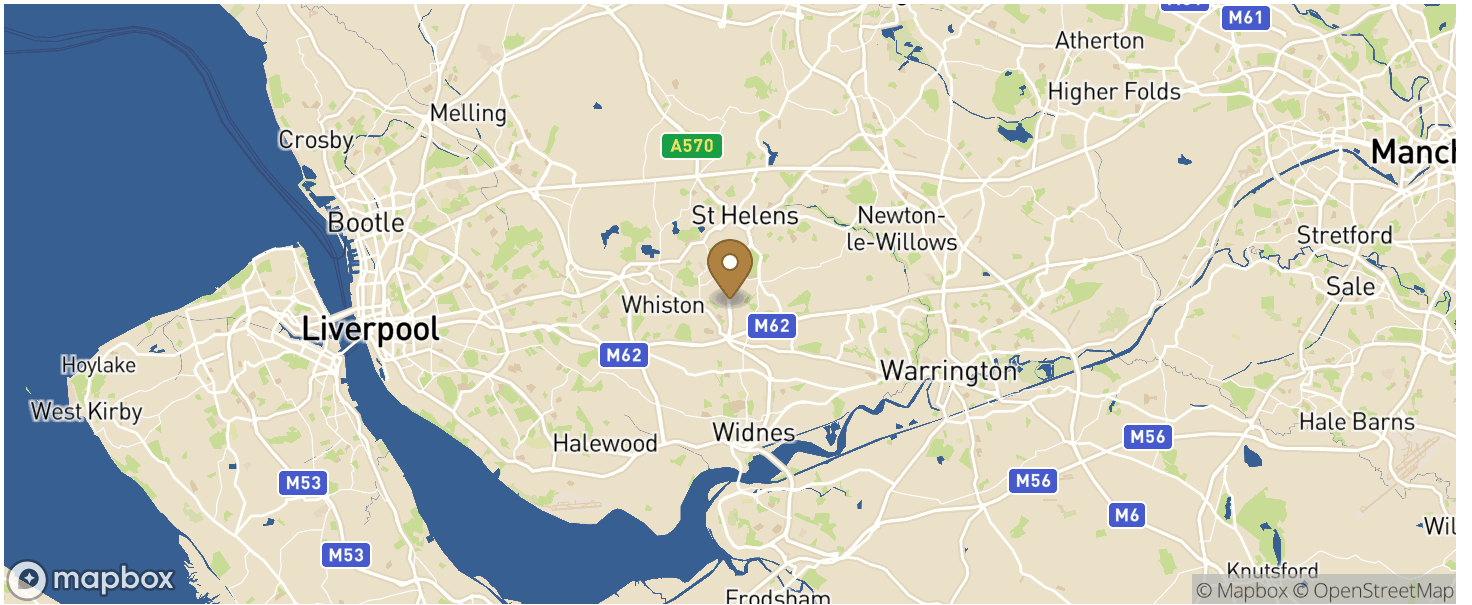

Transportation

Transit

Bus, LEA GREEN RD/OSRAM	4 min walk	0.2 miles
Rail, Lea Green	12 min walk	0.6 miles