



EQT | EXETER



# 10631 South Sam Houston Parkway

Houston, Texas

Building Size: 30,000 SF | 19,036 SF of Industrial Space Available

VISIT [EQTEXETER.COM](http://EQTEXETER.COM)

# 10631 South Sam Houston Parkway

Houston, Texas

Building Size: 30,000 SF | Building Availability: 19,036 SF

## Building Specifications

- Industrial space available
- 30,000 SF total building size
- 19,036 SF available size
- 50% of office space
- 24' clear height
- Rear loading
- 4 dock doors
- 3 doors with ramps total
- 1 oversized door with ramp



# 10631 South Sam Houston Parkway

Houston, Texas

Building Size: 30,000 SF | Building Availability: 19,036 SF

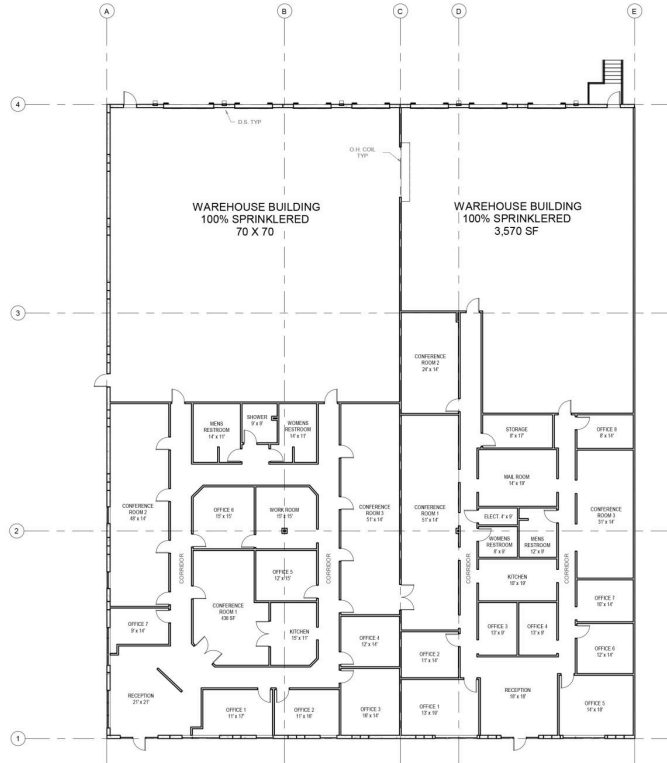

# 10631 South Sam Houston Parkway

Houston, Texas

Building Size: 30,000 SF | Building Availability: 19,036 SF

## Location

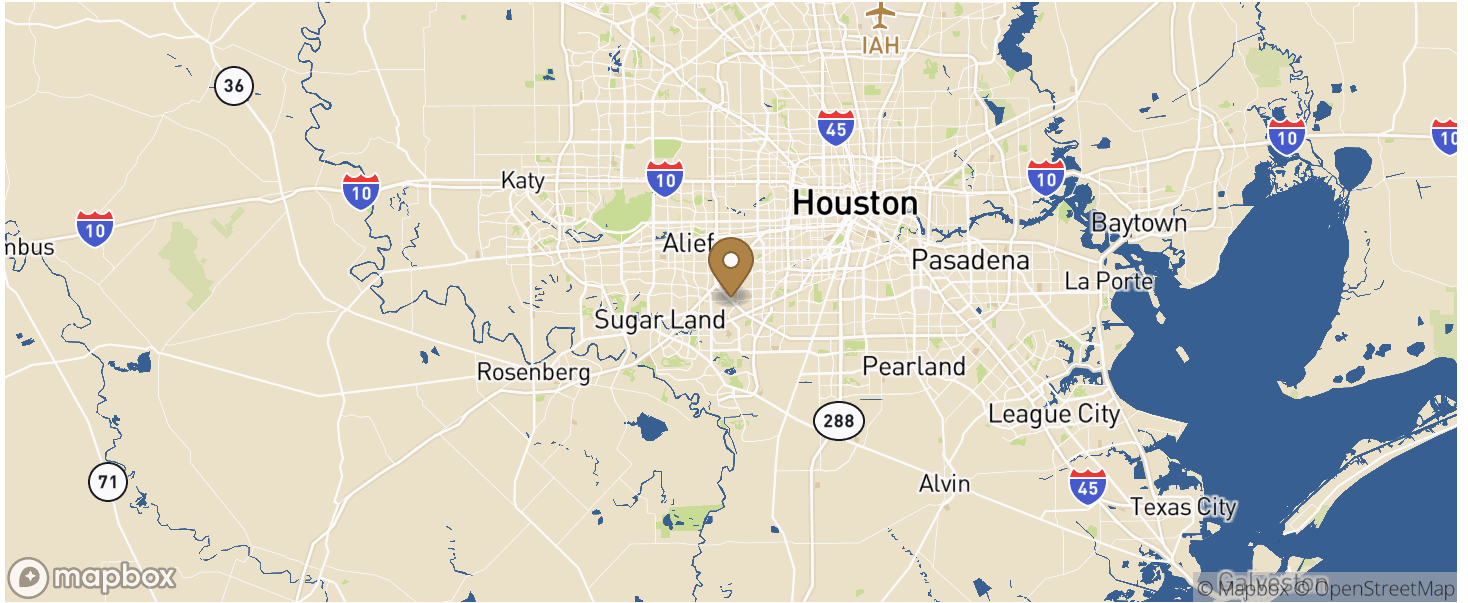

## Population

WITHIN 10 MILES

Total Population	1,361,168
Total Labor Force	820,822
Unemployment Rate	3.54%
Median Household Income	69,733
Warehouse Employees	4,231
High School Education Or Higher	64.10%