



EQT | EXETER



Via Affile

Rome, IT

Building Size: 5,720 SM

VISIT EQTEXETER.COM

Via Affile

Rome, IT

Building Size: 5,720 SM

Building Specifications

- Logistics space
- 5,720 SM total building size
- **Fully Leased**
- 539 SM of office space
- Built in 2005
- 6.3 m to 6.9 m clear height
- 64 dock doors
- 82 car parking spaces

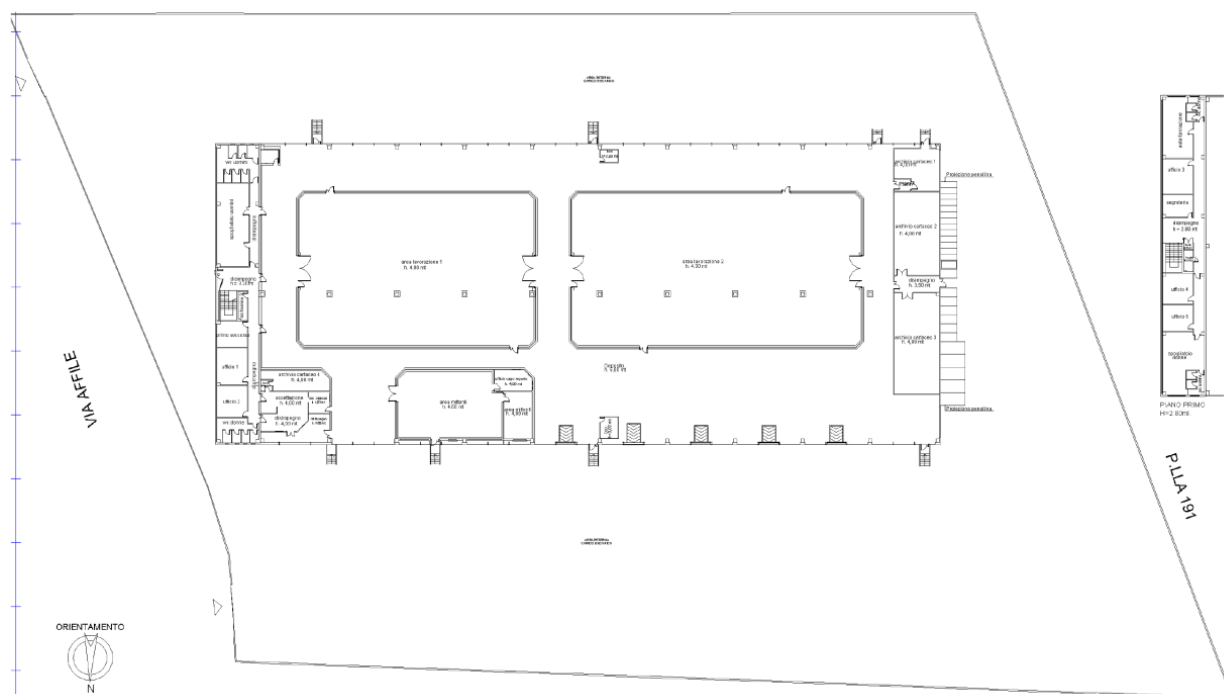

Location

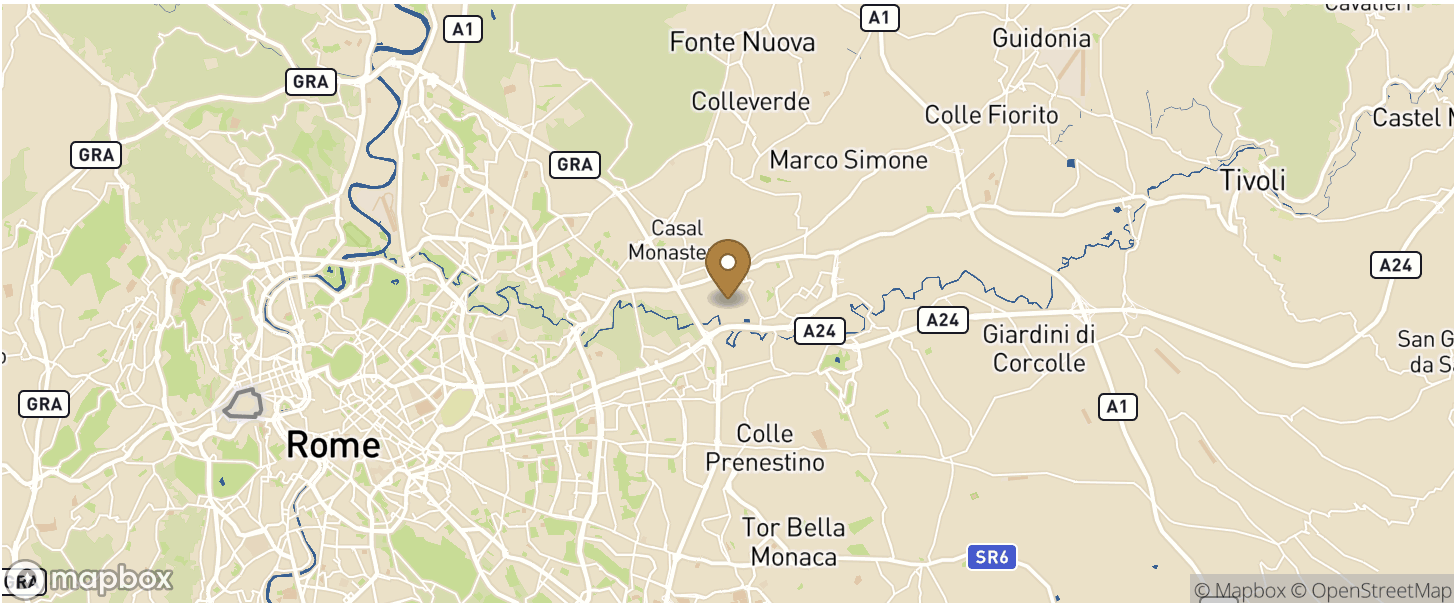

Location Commentary

- The Site is ideally located in central Italy, Rome
- Via Affile is easily accessible due to its vicinity to major motorways and metropolitan road junctions
- The area is recognized as one of the major logistics market in the country, essential for distribution across the rest of Italy due to its central location

Access

CITY	POPULATION	KM	DRIVE TIME
Rome	2,872,800	21	0 h 40 m
Naples	966,144	219	2 h 39 m
Milan	1,366,180	571	6 h 05 m
Turin	870,952	671	7 h 11 m
Munich	1,488,202	919	9 h 46 m
München	1,260,391	920	9 h 48 m

Transportation

Transit

Bus, Cerchiara/Affile	12 min walk	1.0 km
-----------------------	-------------	--------

Via Affile

Rome, IT

Building Size: 5,720 SM

Motorway

SR5 Motorway	3 min drive	1.6 km
--------------	-------------	--------

Motorway

A90 Motorway	6 min drive	1.9 km
--------------	-------------	--------

Airport

Ciampino Airport	15 min drive	20.0 km
------------------	--------------	---------

Airport

Fiumicino Airport	30 min drive	40.2 km
-------------------	--------------	---------

Seaport

Civitavecchia Port	70 min drive	98.2 km
--------------------	--------------	---------