



EQT | EXETER



# Allée de l'Ecoparc Rhéнан

Vendenheim, FR

Building Size: 4 SM | 4 SM of Logistics Space Available

VISIT [EQTEXETER.COM](http://EQTEXETER.COM)

# Allée de l'Ecoparc Rhénan

Vendenheim, FR

Building Size: 4 SM | Building Availability: 4 SM

## Building Specifications

- Logistics space available
- 4 SM total building size
- 4 SM available size
- 270 m x 150 m dimensions
- 2,740 SM of office space
- 3.6 m clear height
- 6T PSM floor load
- 118,11024 truck court depth
- 120 car parking spaces
- 30 trailer parking spaces



## Additional Information

- ICPE: 1510-2-B (E)
- Q1 2024 expected completion date

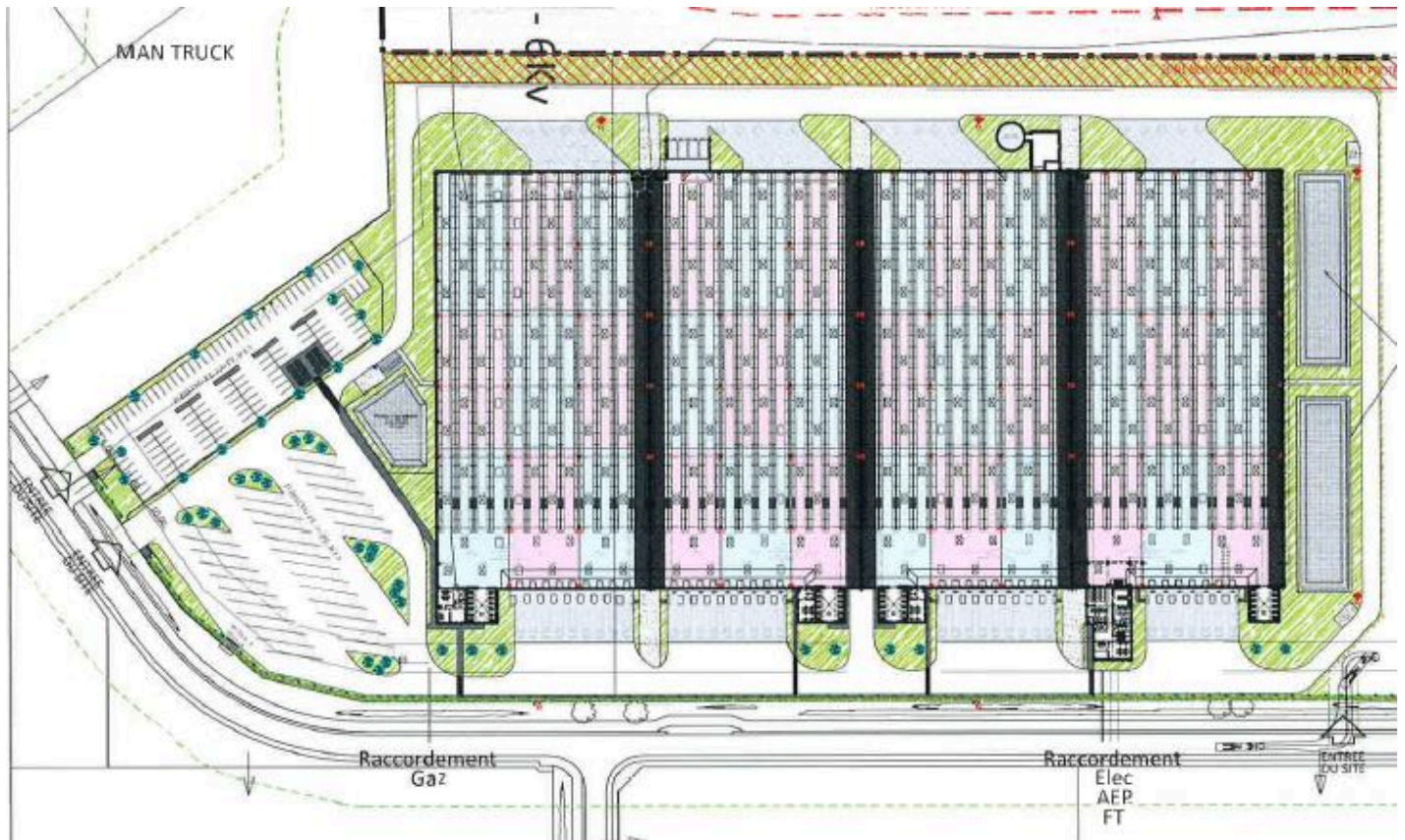

# Allée de l'Écoparc Rhénan

Vendenheim, FR

Building Size: 4 SM | Building Availability: 4 SM

## Location

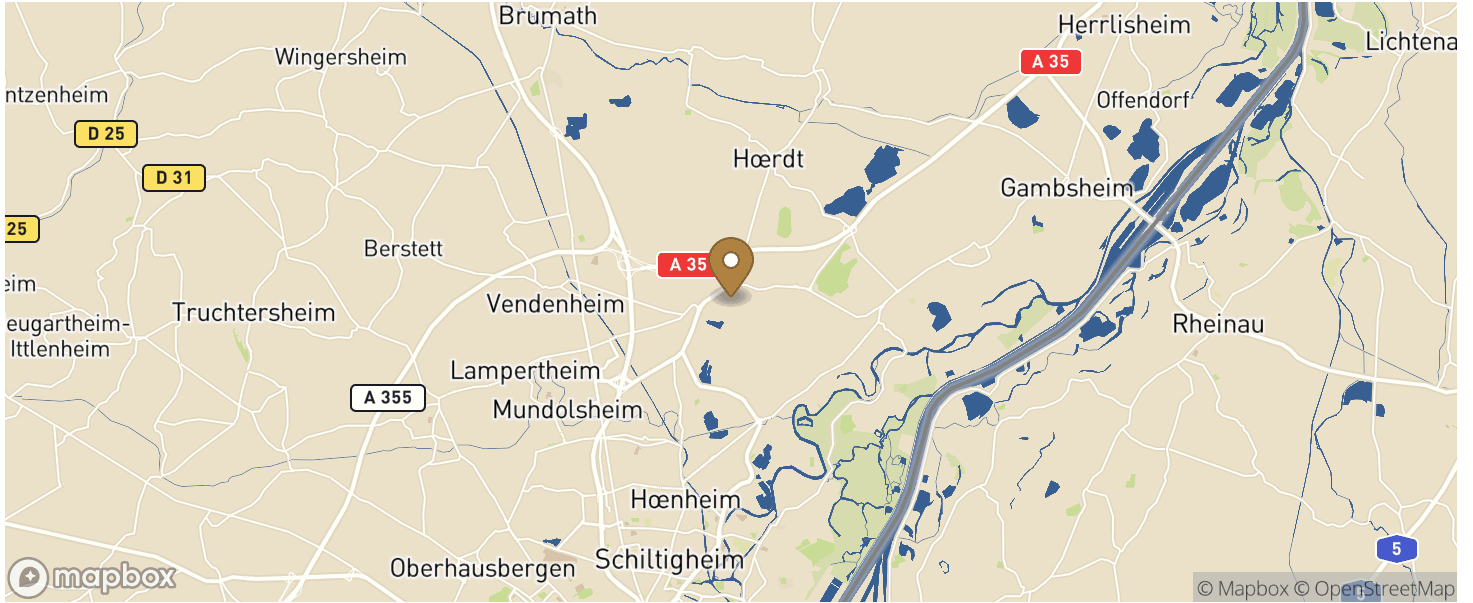

## Location Commentary

- The Property is located in Strasbourg, a 2 hr drive away from Stuttgart and ideally located to serve both national and cross-border locations due to its proximity to the; A4: Connecting Paris, Metz and Strasbourg, A35: Direct motorway to Germany, A355: New motorway to bypass Strasbourg only 10 min away
- Due to its easy access to the port to the North (7 km) and the N353 ring road to the South (5 km), Strasbourg acts as a hub for occupiers across the logistics, manufacturing and agri-food distribution markets

## Access

CITY	POPULATION	KM	DRIVE TIME
Munich	1,488,202	361	4 h 06 m
Paris	2,165,423	484	4 h 48 m
Milan	1,366,180	489	5 h 40 m
Prague	1,301,432	601	6 h 13 m
Hamburg	1,852,478	693	7 h 12 m
Berlin	3,664,088	754	7 h 43 m

## Transportation

### Transit

Bus, ÉcoParc Rhénan

1 min walk

0.1 km



# Allée de l'Ecoparc Rhénan

Vendenheim, FR

Building Size: 4 SM | Building Availability: 4 SM

