



## 18501 Northstar Court

Tinley Park, IL

34,000 SF single-user freezer building with in-place racking

VISIT [EQTEXETER.COM](http://EQTEXETER.COM)

# 18501 Northstar Court

Tinley Park, IL

**Building Size:** 34,000 SF | **Building Availability:** 34,000 SF

## Building Specifications

- Acres: +/- 3.10
- Square feet: 34,000 SF
- Office: 4,000 SF
- Freezer: +/-22,000 SF
- Racking in-place
- Clear height: 29'9"
- Docks: 8 exterior
- Drive-in doors: 1
- Column spacing: 40' x 40'
- Trailer stalls: 18
- Car stalls: 29
- Power: 1,200 amps
- Sprinkler: ESFR
- Immediate access to I-80 via Harlem Avenue
- Minutes to I-57 & I-294

## Additional Information

- Currently configured for distribution with +/-22,000 SF of -24°F high cube freezer area
- Chilled dock area
- Trailer parking stalls and electrical plug-ins
- High-image, precast construction

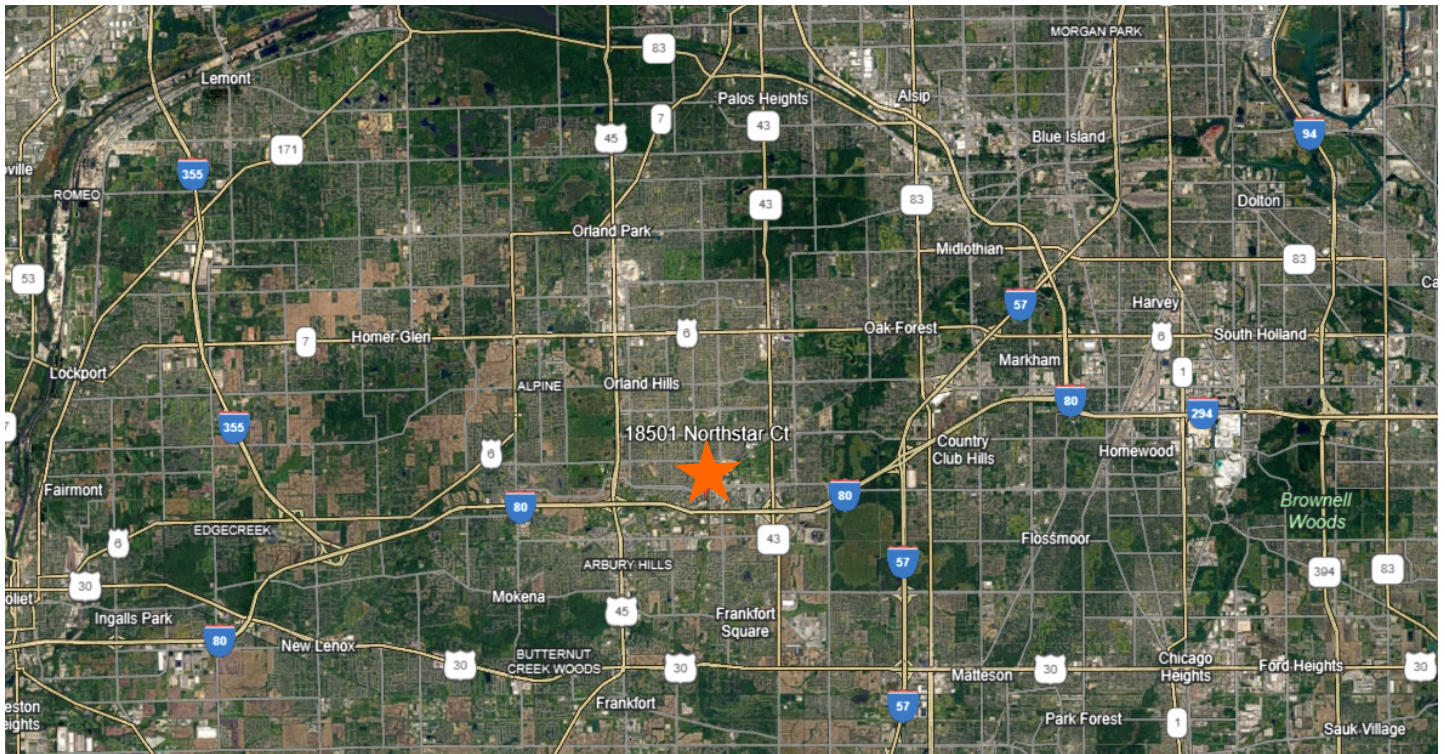

# 18501 Northstar Court

Tinley Park, IL

Building Size: 34,000 SF | Building Availability: 34,000 SF

