



EQT | EXETER



3370 Enterprise Drive

Bloomington, California

Building Size: 112,609 SF | 112,609 SF of Industrial Space Available

VISIT [EQTEXETER.COM](https://eqtexeter.com)

3370 Enterprise Drive

Bloomington, California

Building Size: 112,609 SF | Building Availability: 112,609 SF

Building Specifications

- Industrial space available
- 112,609 SF total building size
- 112,609 SF available size
- ±3,323 SF of Office Space
- 21 Dock High Doors (8'6" x 10')
- 2 Ground Level Door (12' x 24')
- 195' Fully Secured Truck Court
- 32' Minimum Clear Height
- 2,000 amps, Underground Pull Station, 800 amp Meter/Main, 3-phase, 4-wire
- ESFR Fire Sprinkler System
- 3% Skylights
- Excellent I-10, 60 & 215 Freeway Access
- Approximately 12.5 Miles to Ontario Airport

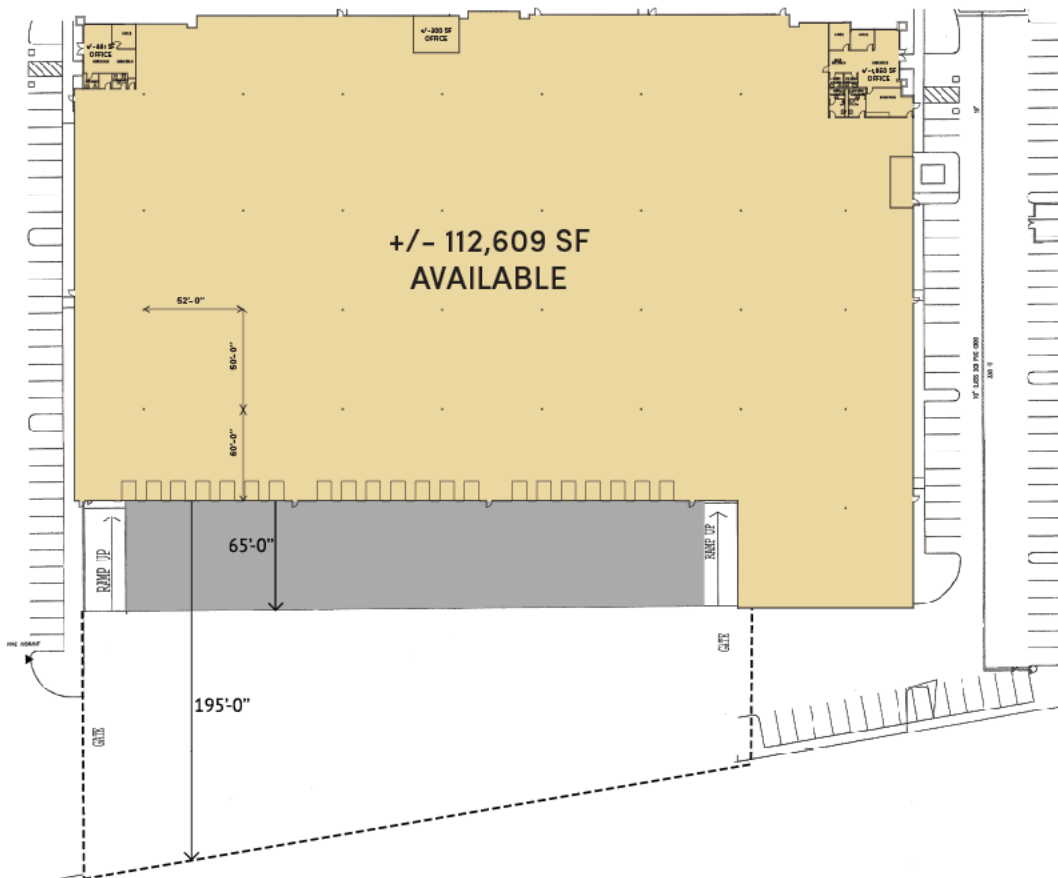

3370 Enterprise Drive

Bloomington, California

Building Size: 112,609 SF | Building Availability: 112,609 SF

Location

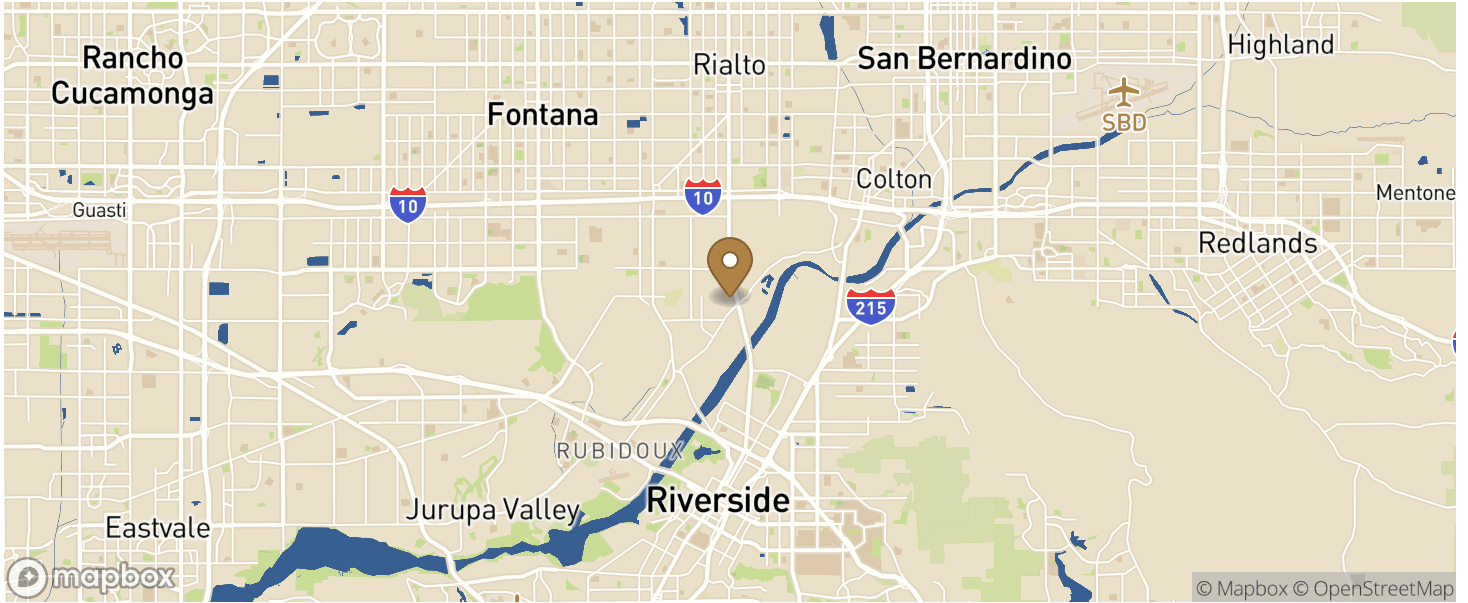

Population

WITHIN 10 MILES

Total Population	779,810
Total Labor Force	398,014
Unemployment Rate	4.89%
Median Household Income	75,350
Warehouse Employees	11,898
High School Education Or Higher	64.65%