



**EQT | EXETER**



# 2225 Cedars Road

Lawrenceville, Georgia

Building Size: 249,600 SF | 38,400 SF of Industrial Space Available

VISIT [EQTEXETER.COM](https://eqtexeter.com)

# 2225 Cedars Road

Lawrenceville, Georgia

Building Size: 249,600 SF | Building Availability: 38,400 SF

## Building Specifications

- Industrial space available
- 249,600 SF total building size
- 38,400 SF available size
- Warehouse SF: 38,324 SF
- Office SF: 4,076 SF
- Clear Height: 28'-9"
- Column Spacing: 40' x 40'
- Parking Ratio: 0.50/1,000 SF
- Sprinklers: Fully Sprinklered
- Dock Doors: 7
- Drive-In Doors: 1
- Endcap of building with ability to secure truck court



## Location

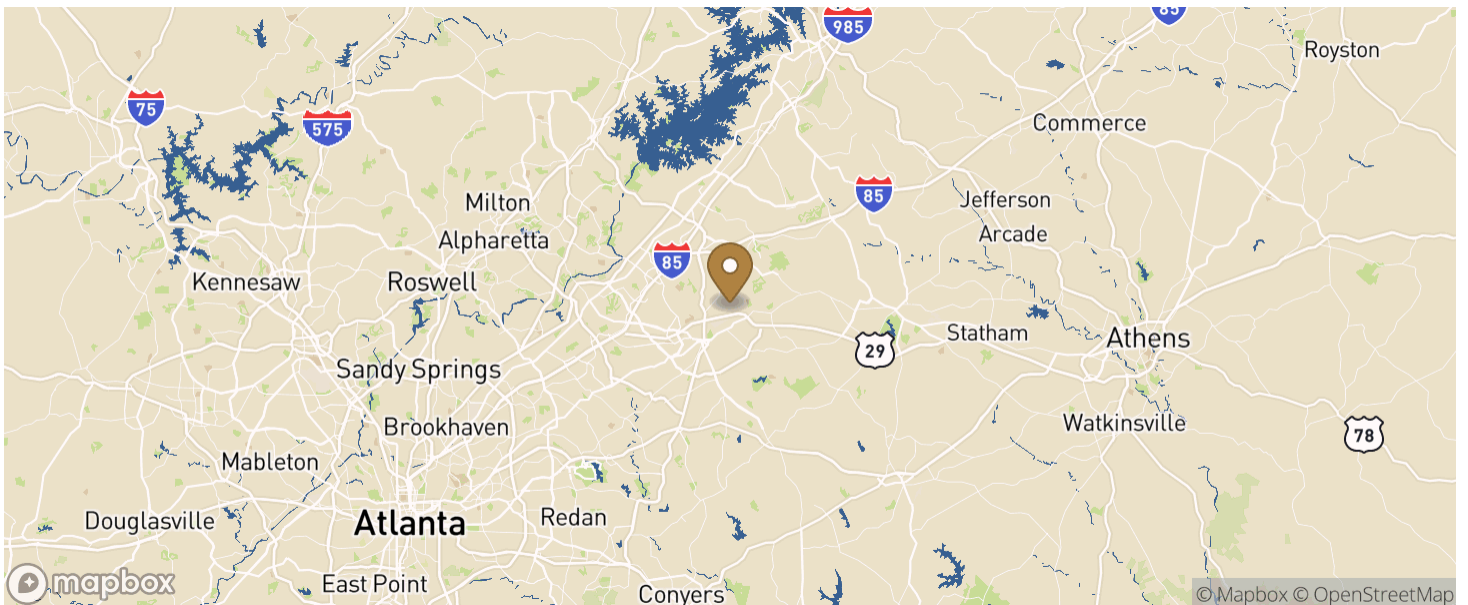

# 2225 Cedars Road

Lawrenceville, Georgia

Building Size: 249,600 SF | Building Availability: 38,400 SF

## Floor Plan

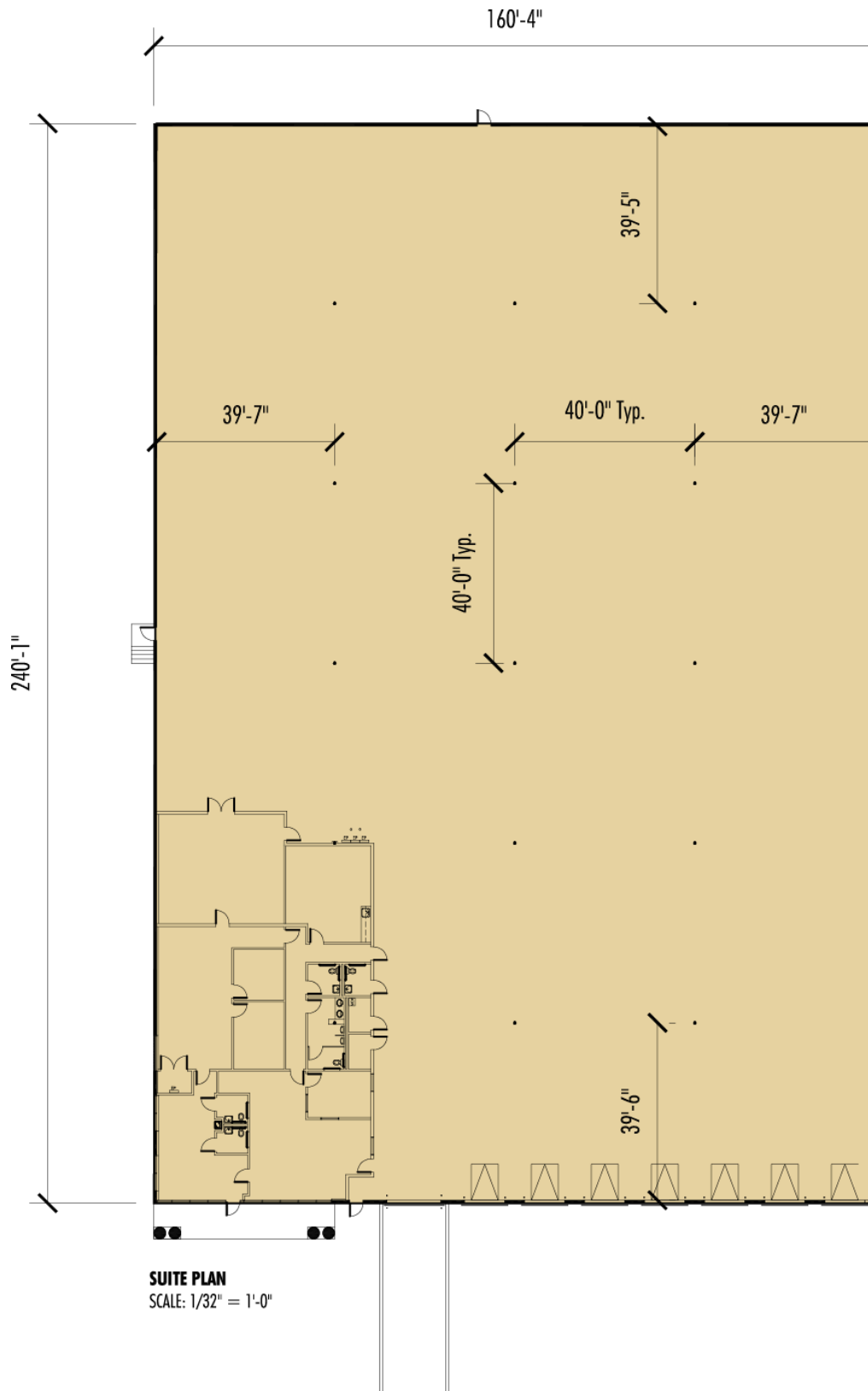

# 2225 Cedars Road

Lawrenceville, Georgia

Building Size: 249,600 SF | Building Availability: 38,400 SF

## Office Plan

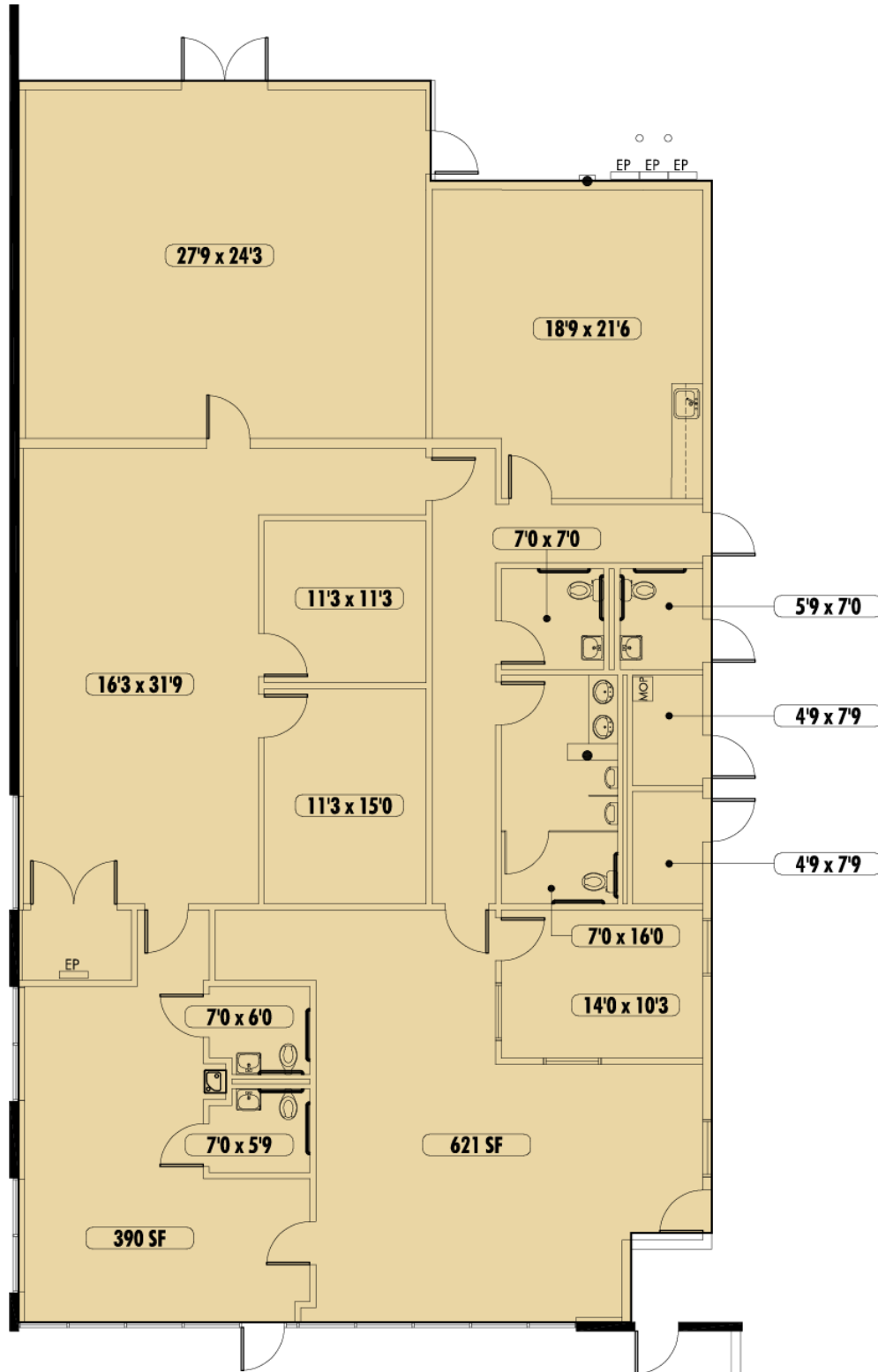

**OFFICE PLAN**  
SCALE: 3/32" = 1'-0"