



EQT | EXETER



Price Road Corridor

1890 & 1900 South Price Road, Chandler, AZ

Campus Size: 241,676 SF | 117,988 SF of Office / Life Science Space Available

VISIT EQTEXETER.COM

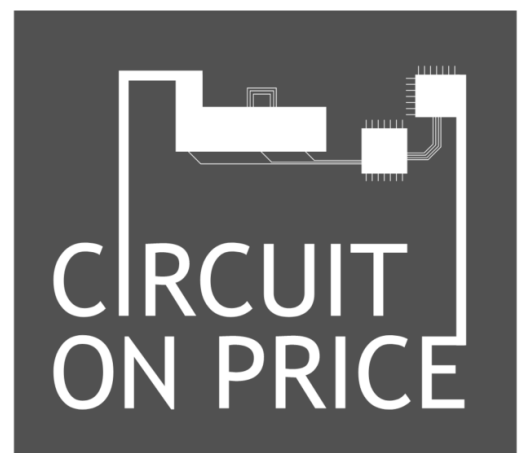

1890 & 1900 South Price Road

Chandler, AZ

Campus Size: 241,676 SF | Building Availability: 117,988 SF

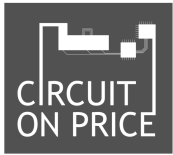

Building Specifications

- 117,988 SF of Office/Life Science Space
- Zoning: City of Chandler, planned area development (PAD)
- Parking Ratio: +/-3.76 per 1,000 SF; +/- 3.0 per 1,000 covered
- Building A2 - 1900 South Price Road
 - +/- 41,590 SF
 - 2 story
 - Year Built: 1997
- Building A3 - 1890 South Price Road
 - +/- 76,398 SF
 - 3 story
 - Year Built: 2002



New Exterior Lounge



Building A2 - 1900 South Price Road



Building A3 - 1890 South Price Road

1890 & 1900 South Price Road

Chandler, AZ

Campus Size: 241,676 SF | Building Availability: 117,988 SF

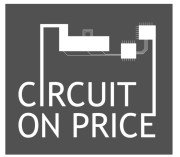

Interior

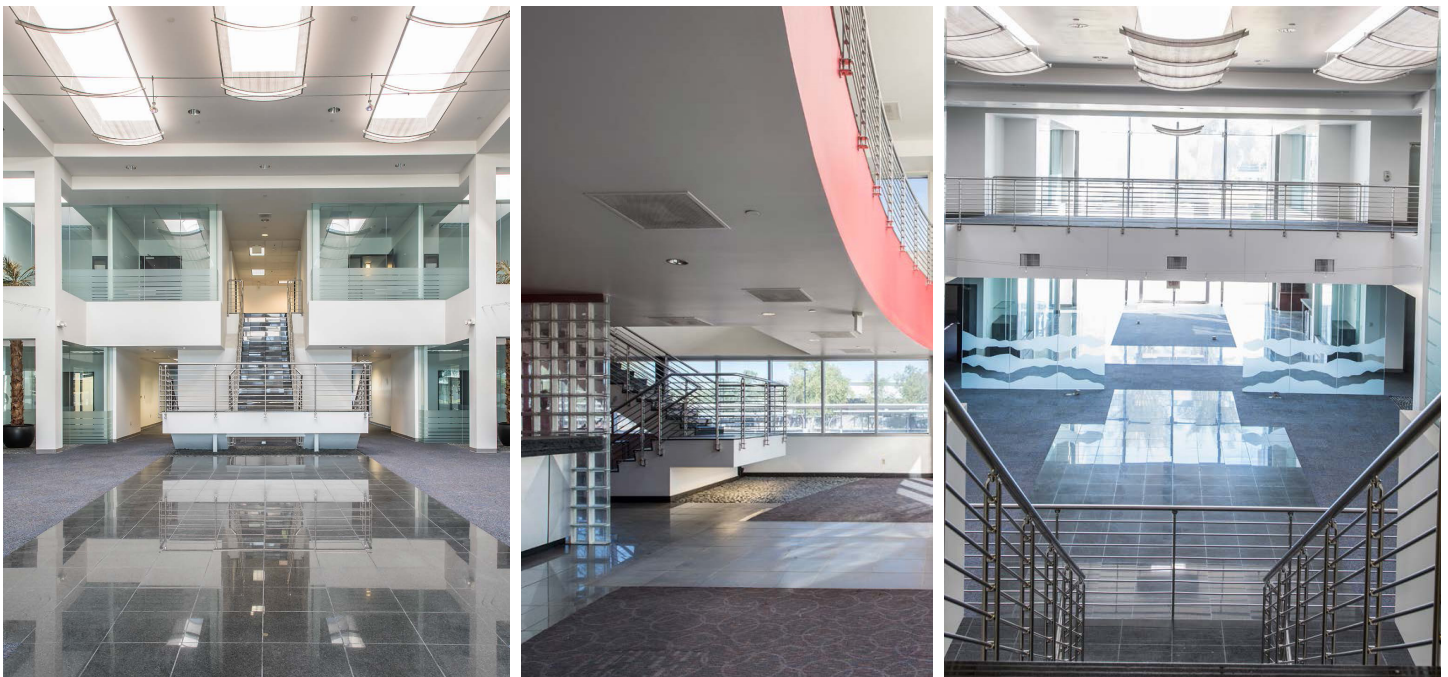

1890 & 1900 South Price Road

Chandler, AZ

Campus Size: 241,676 SF | Building Availability: 117,988 SF



Location Highlights

Located within the heart of the prestigious Price Road Corridor of Chandler, Arizona. The property has convenient access to Loop 101 and Loop 202 freeway intersection. Chandler has attracted numerous high-tech industrial tenants such as Intel, NXP Semiconductors, Microchip Technology, Northrop Grumman, Avnet, Rogers Corporation, Isola, and Everspin Technologies.

